

EDGEWATER MARINA FINAL SITE PLAN

EDGEWATER, FLORIDA

GENERAL NOTES

1. TAX PARCEL NUMBER: 02-18-34-3704-0010
2. EXISTING ZONING: B-4 TOURIST COMMERCIAL
3. PROPERTY ADDRESS: 2001 SOUTH RIVERSIDE DRIVE
4. PROPOSED ZONING PUD
5. BOUNDARY, TREE, AND TOPOGRAPHY SURVEY PREPARED BY: DANIEL W. CORY, SURVEYOR, LLC FILE NO. 1602013 DATED: FEB. 17, 2016
6. LOCATIONS OF EXISTING UTILITIES ARE SHOWN BASED ON AVAILABLE INFORMATION. IT IS THE CONTRACTOR'S RESPONSIBILITY TO DETERMINE THE EXACT LOCATION OF EXISTING UTILITIES AND TO DETERMINE IF OTHER UTILITIES WILL BE ENCOUNTERED DURING THE COURSE OF THE WORK AND TAKE WHATEVER STEPS NECESSARY TO PROVIDE FOR THEIR PROTECTION (E.G. SHEETING, DE-WATERING, ETC.). CONTRACTOR TO NOTIFY DESIGN ENGINEER OF ANY DISCREPANCIES OR CONFLICTS.
7. THERMOPLASTIC STRIPING AND TRAFFIC CONTROL SIGNAGE TO MEET FDOT AND CITY OF EDGEWATER SPECIFICATIONS.
7. TRAFFIC CONTROL SIGNS TO BE IN ACCORDANCE WITH F.D.O.T. STANDARD SPECIFICATIONS - ALL STOP SIGNS, SPEED LIMIT AND STREET SIGNS REQUIRED TO BE PROVIDED BY DEVELOPER TO CITY OF EDGEWATER SPECIFICATIONS.
9. ALL TRAFFIC CONTROL SIGNS SHALL BE FABRICATED IN ACCORDANCE WITH THE MANUAL ON UNIFORM TRAFFIC CONTROL DEVICES USING 3M BRAND "SCOTCHLIGHT" SHEETING (ENGINEER GRADE) ON MINIMUM 0.080 GAUGE 5052-H38 ALUMINUM BLANKS. ALL STOP SIGNS SHALL BE HIGH INTENSITY 30" OCTAGON INSTALLED ON 12" x 3 LBS/FT. "U" CHANNEL POSTS (RAIL STEEL ONLY) OR 3" x 12" ROUND ALUMINUM POSTS. "U" CHANNEL POSTS MAY BE USED FOR ALL SIGNS SMALLER THAN 36" x 48". ALL WARNING SIGNS SHALL BE 30" x 30".
10. THE CONTRACTOR SHALL OBTAIN ALL REQUIRED PERMITS AND/OR LICENSES TO COMMENCE CONSTRUCTION.
11. ALL CONCRETE SHALL DEVELOP A 28-DAY COMPRESSIVE STRENGTH OF 3,000 PSI UNLESS OTHERWISE NOTED.
12. THE CONTRACTOR SHALL HAVE AVAILABLE AT THE JOB SITE, AT ALL TIMES, ONE COPY OF PLANS, SPECIFICATIONS, AND COPIES OF ANY REQUIRED CONSTRUCTION PERMITS.
13. CONTRACTOR IS RESPONSIBLE FOR CHECKING ACTUAL SITE CONDITIONS BEFORE STARTING CONSTRUCTION.
14. ANY DISCREPANCIES ON THE DRAWINGS SHALL BE BROUGHT TO THE ATTENTION OF THE ENGINEER BEFORE COMMENCING WORK.
15. NO FIELD CHANGES OR DEVIATIONS FROM DESIGN TO BE MADE WITHOUT PRIOR APPROVAL FROM THE ENGINEER.



LOCATION MAP

TABLE OF CONTENTS

| SHEET NO. | DESCRIPTION |
|-----------|-------------------------------------|
| 1 | COVER SHEET |
| 2 | SURVEY |
| 3 | DEMOLITION AND EROSION CONTROL PLAN |
| 4 | SITE PLAN |
| 5 | CIVIL PLAN |
| 6 | UTILITY PLAN |
| 7 | LANDSCAPE PLANS |
| 8 | LANDSCAPE DETAILS |
| 9 | IRRIGATION PLAN |
| 10 | IRRIGATION DETAILS |
| 11-12 | PAVING AND DRAINAGE DETAILS |
| 13 | WATER STANDARD DETAILS |
| 14 | SEWER STANDARD DETAILS |

PARKER MYNCHENBERG & ASSOCIATES, INC.

PROFESSIONAL ENGINEERS * LANDSCAPE ARCHITECTS
1729 RIDGEWOOD AVENUE HOLLY HILL, FLORIDA 32117
(386) 677-6891 FAX (386) 677-2114 E-MAIL: info@parkermynchenberg.com
CERTIFICATE OF AUTHORIZATION NO. 00003910

GENERAL INFORMATION

PROJECT NAME:

EDGEWATER MARINA
FINAL SITE PLAN
2001 SOUTH RIVERSIDE DR
EDGEWATER, FLORIDA 32141

PROJECT NAME:

LOT 1, BLOCK 4, RIVEREDGE ACRES, ACCORDING TO THE MAP OR PLAT THEREOF, AS RECORDED IN MAP BOOK 9, PAGE 260, OF THE PUBLIC RECORDS OF VOLUSIA COUNTY, FLORIDA.

OWNER:

ASKI DEVELOPMENT LLC
RICHARD KOWALSKI, MANAGER
524 GREELEY STREET
ORLANDO, FL 32804
(407) 872-2400 FAX (407) 898-4089
EMAIL: freon@trsuppliers.com

ENGINEER / LANDSCAPE ARCHITECT:

PARKER MYNCHENBERG & ASSOC., INC.
PARKER MYNCHENBERG, P.E. #32645, L.A. #1553
1729 RIDGEWOOD AVENUE
HOLLY HILL, FLORIDA 32117
(386) 677-6891

SURVEYOR:

DANIEL W. CORY SURVEYOR, LLC
DANIEL W. CORY P.S.M. 2027
300 CANAL STREET
NEW SMYRNA BEACH, FLORIDA 32168
(386) 427-9575 FAX (386) 427-1783

RECEIVED

April 12, 2019

DEVELOPMENT SERVICES

LAND USE TABULATION

TOTAL SITE AREA =
1. ABOVE MEAN HIGH WATER ELEVATION ±0.80 AC.
2. BELOW MEAN HIGH WATER ELEVATION ±0.46 AC.
TOTAL SITE AREA ±1.26 AC.

BOSTON ROAD 60' ROW 18626.40 S.F. 0.49 AC.

BUILDING AREA:
1ST FLOOR 5,610 SF
2ND FLOOR 318 SF
TOTAL 5,928 SF = 17.01% COVERAGE

PROPOSED IMPERVIOUS AREA:

PROPOSED BUILDING (1ST FLOOR) = 5,610 SF.

PROPOSED PAVEMENT = 29,712 SF.

(INCLUDES BOSTON RD ROW)

PROPOSED BOARDWALK = 2,416 SF.
TOTAL = 37,738 SF. = 0.86 AC. = 68.76%
LANDSCAPE AREA = 0.39 AC. = 31.24%

PARKING REQUIREMENTS:

4,432 SF 156 SEAT RESTAURANT WITH FULL BAR, 1,355 SF
BAIT AND TACKLE SHOP & 141 SF RENTAL OFFICE
152 SEAT/4 = 38
10 EMPLOYEES* 1 SPACE/2 WORKERS = 5
1,355 SF*/250 RETAIL SALES = 5.42
141 SF*/250 RENTAL OFFICE = 0.56
TOTAL PARKING REQUIRED: 49

PARKING PROVIDED:

STANDARD 53
HANDICAP 3
TOTAL PROVIDED 56 SPACES

PARKING PROVIDED FOR NORTHEAST SINGLE FAMILY LOT:

STANDARD 4 SPACES

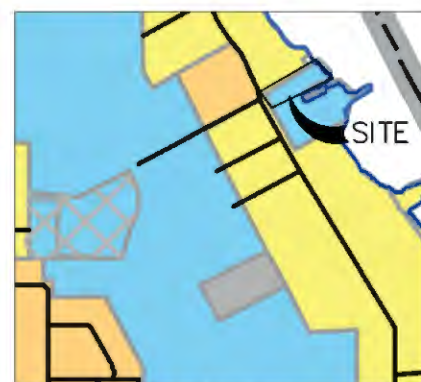

FUTURE LAND USE
LAND USE: COMMERCIAL



ZONING MAP
ZONING: B-4 TOURIST COMMERCIAL



SOILS MAP



FLOOD MAP
ZONE AE

| NO. | DATE | DESCRIPTION | BY |
|---------------------|------------|------------------|-------------|
| 5 | 4/12/19 | REVISED PER CITY | PKM |
| 4 | 3/15/19 | REVISED PER CITY | PKM |
| 3 | 3/3/19 | REVISED | PKM |
| 2 | 11/18/18 | REVISION | PKM |
| 1 | 10/11/18 | REVISION | PKM |
| REVISIONS | | | |
| COVER SHEET | | | |
| EDGEWATER MARINA | | | |
| EDGEWATER * FLORIDA | | | |
| FILE NO. | 1752CS.DWG | DESIGNER: | MYNCHENBERG |
| DATE: | 7/17/2018 | DRAFTSMAN: | SLB |
| SCALE: | NO SCALE | SHEET | 1 OF 14 |

Lot 1, Block 4, Riveredge Acres, according to the map or plat thereof, as recorded in Map Book 9, Page 260, of the Public Records of Volusia County, Florida.

1. Description per Warranty Deed recorded in Official Records Book 7194, Page 3847 of the Public Records of Volusia County, Florida.
2. Bearings refer to U. S. Army Corps of Engineers map of the Intracoastal Waterway, (D. O. File No. 8A-30,014) and based on the calculated direction between Corps of Engineers monument 1WV-170 (X= 533,370.18, Y= 1,688,108.53) and Corps of Engineers monument 1WV 172 (X= 534,609.75, Y= 1,685,610.80) as being South 26° 23' 39" East. The published coordinates listed above are based on the Florida State Plane Coordinate System - East Zone (1927 Adjustment).
3. Subject to restrictions, reservations, limitations, easements and rights of way, if any, appearing of record.
4. This map of survey and report prepared without the benefit of an abstract and no title work has been performed or provided to this surveyor.
5. This map of survey and report is subject to any facts that may be disclosed by a full and accurate title search.
6. The location of any subsurface foundations, improvements, features or utilities which may or may not exist and which may or may not violate deed or easement lines are not determined or addressed by this survey.
7. Dimensions indicated hereon are in U.S. standard feet and decimals thereof, unless otherwise noted.
8. Elevations indicated hereon are in feet and decimals referenced to **North American Vertical Datum 1988** and are based on United States Coastal and Geodetic Survey monument S-211, published elevation 10.60 feet.
9. Unless otherwise noted, the monumentation has no identification number or name.
10. Drawing distance between features and property line may be exaggerated for clarity.
11. Features shown by symbol as indicated are not to scale.
12. Ownership of fences shown hereon is not addressed by this survey.
13. The direction and location of riparian lines was not determined. Adjacent docks not located.
14. Wetlands line not determined or located.
15. Mean High Water Elevation **0.30 feet (North American Vertical Datum 1988)** based on extension of tidal datum from Florida Department of Environmental Protection MHW Data Point No. 4012, National Tidal Epoch 1983-2001. Mean High Water elevation provided by the Land Boundary Information System internet web site (www.labris.org). This is not a Mean High Water Survey and does not comply with Chapter 177, Part II, Florida Statutes.
16. The intended topographic features located and shown on this survey are the spot elevations.
17. There are no trees on the subject parcel.
18. The contours are approximate and were interpolated from the spot elevations shown hereon.
19. Notice Regarding Intracoastal Waterway Right-of-way (dock repairs and construction) recorded in Official Records Book 4297, Page 2888 of the Public Records of Volusia County, Florida. Intracoastal Waterway right of way line not located.
20. Subject to Terms and Conditions of Sovereign Submerged Land Lease recorded in Official Records Book 6385, Page 4184 of the Public Records of Volusia County, Florida.
21. NOTICE: THE EXISTENCE OF AN UNDERGROUND FLORIDA POWER & LIGHT COMPANY DISTRIBUTION LINE AND SUBAQUEOUS FLORIDA POWER & LIGHT COMPANY DISTRIBUTION LINE IN THE RIGHT OF WAY OF "BOSTON ROAD" WAS NOT INVESTIGATED.
22. Additions or deletions to this survey map or report by other than the signing party or parties is prohibited without written consent of the signing party or parties per F.A.C. Rule 5J-17.051(3)(b)6.
23. The survey map and report or copies thereof are not valid without the signature and the original raised seal of a Florida licensed surveyor and mapper.

CERTIFIED TO: ASKI DEVELOPMENT, LLC

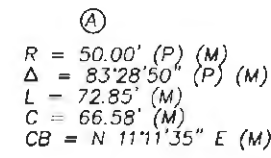



| <i>TYPE</i> | <i>SURVEY DATE</i> | <i>WORK ORDER #</i> | <i>P.C.</i> | <i>CALC.</i> | <i>DRAFT</i> | <i>CHECKED</i> |
|--------------------|--------------------|---------------------|-------------|--------------|--------------|----------------|
| BOUNDARY SURVEY | 02/17/2016 | 16-02-013 | M.T.Q. | J.W.C. | BTC/JWC | J.W.C. |
| TOPOGRAPHIC SURVEY | 02/17/2016 | 16-02-013 | M.T.Q. | J.W.C. | BTC/JWC | J.W.C. |
| | | | | | | |
| | | | | | | |
| | | | | | | |
| | | | | | | |
| | | | | | | |
| | | | | | | |
| <i>TYPE</i> | <i>DATE</i> | <i>WORK ORDER #</i> | <i>--</i> | <i>CALC.</i> | <i>DRAFT</i> | <i>CHECKED</i> |
| CAD REVISION | 04/14/2016 | (16-02-013) | -- | J.W.C. | B.T.C. | J.W.C. |
| | | | | | | |
| | | | | | | |

CERTIFICATE OF AUTHORIZATION NUMBER LB 7883

I hereby certify that this survey map and report of the subject property is true and correct to the best of my knowledge, information and belief as surveyed in the field under my supervision on the dates shown hereon. I further certify that this survey map and report meets the minimum technical standards set forth in F.A.C. Rule 5J-17, adopted by the Florida Board of Professional Surveyors and Mappers, pursuant to Florida Statutes Ch. 472.027, subject to the qualifications noted hereon.

DANIEL W. CORY **P.S.M. NO. 202**
JEFFREY W. CORY **P.S.M. NO. 41**

| | | | |
|--|------|---|------------------------|
| THIS PROPERTY IS LOCATED IN F.R.M. ZONE(S) | | X* (SHADED) * AE (EL. 6') | |
| THIS LOCATION IS DETERMINED FROM F.R.M. COMMUNITY | | | |
| PANEL 125132 | 0542 | H | MAP REVISED 02/19/2014 |
|  | |  | |
| DANIEL W. CORY SURVEYOR, LLC 300 CANAL STREET NEW SMYRNA BEACH, FLORIDA 32168 (386) 427-9575 FAX (386) 427-1783 web site: corysurveyor.com | | | |
| PREPARED FOR: ASKI DEVELOPMENT, LLC | | | |
| SCALE 1" = 20' | | FILE # 3532 | |

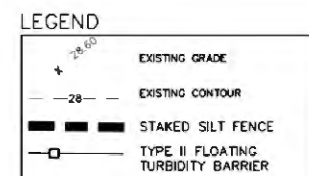
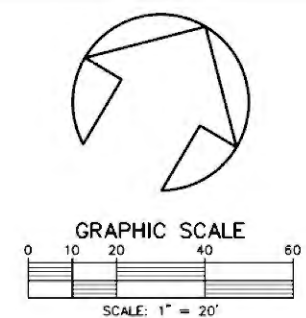

STORMWATER MANAGEMENT PLAN

CLEARING AND PREPARATION

- PRIOR TO ANY CLEARING OR GRUBBING ALL EROSION CONTROL FEATURES SHALL BE PROPERLY INSTALLED IN ACCORDANCE WITH DETAILS.
- DURING THE CLEARING, GRUBBING AND SITE GRADING STAGES, AREAS THAT ARE DISTURBED MORE THAN 7 DAYS SHALL BE STABILIZED WITH GRASS SEED APPLIED AT MANUFACTURER'S RECOMMENDATIONS. AFTER SEEDING, EACH AREA SHALL BE MULCHED WITH 4,000 POUNDS OF STRAW PER ACRE, OR SHALL BE SOODED. ALL EROSION CONTROL MEASURES SHALL BE MAINTAINED UNTIL THE EROSION CONTROL BLANKET SHALL BE UTILIZED UNTIL THE AREA ACHIEVES FINAL STABILIZATION.
- AFTER THE INITIAL SITE GRADING WORK, ALL PROPOSED INLETS(S)/OUTFALLS, ONCE INSTALLED, SHALL BE PROTECTED FROM EROSION AND SEDIMENT RUNOFF BY THE USE OF FILTER FABRIC. DISTURBED PORTIONS OF THE SITE WHERE CONSTRUCTION ACTIVITIES HAVE PERMANENTLY CEASED SHALL BE STABILIZED WITH PERMANENT SEEDING. OTHER PERMANENT STABILIZATION METHODS NO LATER THAN 14 DAYS AFTER THE LAST CONSTRUCTION ACTIVITY. SEEDING SHALL BE THE SAME AS IN TEMPORARY SEEDING.
- ALL INSTALLATION SHALL BE COMMENCED AS DEPICTED ON THE PLANS.
- TEMPORARY SEEDING SHALL BE GRASS APPLIED AT MANUFACTURER'S RECOMMENDATIONS TO ANY DISTURBED AREA THAT IS INACTIVE MORE THAN 7 DAYS.
- MULCHING PRACTICES AND SOO SHALL BE APPLIED THROUGHOUT THE SITE.
- SOO SHALL BE USED TO STABILIZE THE RETENTION POND AS IDENTIFIED IN THE SECTION.
- ALL DISTURBED AREAS SHALL BE STABILIZED UPON COMPLETION OF EARTHWORK. CONTRACTOR SHALL UTILIZE BEST MANAGEMENT PRACTICES TO PREVENT EROSION AND SEDIMENTATION FROM OCCURRING ON GRADUATED AREAS.
- SILT FENCES HAVE BEEN IDENTIFIED ON THE PLANS. CONTRACTOR SHALL STRICTLY ADHERE TO THE SPECIFIED LOCATIONS AND PERIODICALLY INSPECT THE STRUCTURAL CONTROLS TO DETERMINE IF THEY ARE CONSISTENT WITH THE DETAILS PROVIDED ON THE CONSTRUCTION PLANS. CONTRACTOR SHALL MAKE ALL NECESSARY REPAIRS TO ENSURE THAT THE STRUCTURAL CONTROLS ARE PROPERLY INSTALLED.
- DEDICATING FOR RETENTION DETENTION PONDS SHALL BE A PERFORATED SOO. ALL SYSTEMS FOR WATER DISCHARGED TO THE EXISTING WETLANDS SHALL BE CLEAN AND FREE OF TURBIDITY.
- ALL STORMWATER MANAGEMENT PONDS SHALL BE ROUGHLY GRADED PRIOR TO ANY OTHER WORK. SILT FENCES AND FLOATING TUBOY BARRIERS SHALL BE INSTALLED PRIOR ANY EARTHWORK.
- CONTRACTOR SHALL USE ALL MEANS NECESSARY TO REMOVE DIRT AND SILT FROM VEHICLES PRIOR TO EXITING THE PROJECT SITE. SUCH MEASURES SHALL INCLUDE WASHING DOWN THE VEHICLE WITH WATER OR USING FORMED CONCRETE IN A SMALL AREA WHICH SHAKES VEHICLES TO REMOVE THE DIRT.

INSPECTIONS

- THE RESPONSIBLE ENTITY SHALL INSPECT QUARTERLY ALL STRUCTURAL AND NON-STRUCTURAL CONTROLS TO ASSURE THAT ARE IN GOOD OPERATING CONDITIONS. SKIMMER BOARDS SHALL BE REPLACED IF THEY APPEAR TO BE IN POOR CONDITION. ALL FASTENERS SHALL BE CHECKED TO VERIFY THEY ARE IN GOOD WORKING ORDER. INSPECTION OF NON-STRUCTURAL CONTROLS OF THE WET PONDS SHALL BE CLEANED TO ASSURE THAT CLOGGING WILL NOT DEVELOP.
- THE STORMWATER PONDS SHALL BE INSPECTED TO VERIFY THAT NO BREACHES HAVE DEVELOPED WHICH WOULD RENDER THEM LESS EFFECTIVE. THE PONDS SHALL BE MOVED AT A MINIMUM OF ONCE EVERY TWO WEEKS. ADDITIONAL MAINTENANCE MAY BE REQUIRED IF A VIOLATION OF THE CONTROL MEASURES SHALL BE REMOVED TO ASSURE THAT THEY ARE IN PROPER WORKING ORDER.
- ONCE A WEEK OR WITHIN 24 HOURS FOLLOWING A RAINFALL EVENT OF 0.5 INCHES OR MORE, THE SITE SHALL BE INSPECTED TO VERIFY IF AN EROSION CONTROL MEASURE IS FUNCTIONING PROPERLY. LOCATION, TYPE OF CONTROL, DATE IMPLANTED, CURRENT CONDITION, AND CORRECTIVE ACTION SHALL BE REPORTED.
- STORMWATER POLLUTION PREVENTION PLAN CONSTRUCTION INSPECTION REPORT MUST BE COMPLETED WEEKLY OR AFTER 0.25 INCHES OF RAINFALL.

| | | | |
|-------------------|----------|------------------|-----|
| 5 | 4/12/19 | REVISED PER CITY | PKM |
| 4 | 3/15/19 | REVISED PER CITY | PKM |
| 3 | 3/3/19 | REVISED | PKM |
| 2 | 11/18/18 | REVISION | PKM |
| 1 | 10/11/18 | REVISION | PKM |
| NO. | DATE | DESCRIPTION | BY |
| R E V I S I O N S | | | |

**PARKER MYNCHENBERG
& ASSOCIATES, INC.**
PROFESSIONAL ENGINEERS • LANDSCAPE ARCHITECTS
1729 RIDGEWOOD AVENUE HOLLY HILL, FLORIDA 32117
(386)677-6891 FAX(386)677-2114 E-MAIL: info@parkermynchenberg.com
CERTIFICATE OF AUTHORIZATION NUMBER: 00003310.....

DEMOLITION AND EROSION CONTROL PLAN
EDGEWATER MARINA

| | |
|---------------------|--------------------------|
| EDGEWATER * FLORIDA | |
| FILE NO. 1752SP.DWG | DESIGNER: P. MYNCHENBERG |
| DATE: 7/17/2018 | CADD TECH: SLB |
| SCALE: 1" = 20'-0" | SHEET 3 OF 14 |

EROSION CONTROL PLAN GENERAL NOTES

1. INSPECTION OF EROSION CONTROL MEASURES IS REQUIRED AFTER A 0.50" OR GREATER RAINFALL.
2. ALL DISTURBED AREAS TO BE SOODED.
3. A DUMPSITE OF SUITABLE SIZE SHALL BE PROVIDED DURING THE ENTIRE CONSTRUCTION PERIOD. THE DUMPSITE SHALL BE EMPTIED AND REPLACED AS NEEDED. ALL MUDSUE GENERATED ONSITE SHALL BE DISPOSED OF AT A PERMITTED WASTE MANAGEMENT FACILITY.
4. DEVELOPER/CONTRACTOR SHALL OBTAIN AN FDEP-INPDS PERMIT FOR CONSTRUCTION GENERAL PERMIT PRIOR TO ANY CONSTRUCTION COMMENCEMENT.

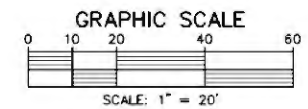

LEGEND

| | |
|--|---|
| | EXISTING GRADE |
| | EXISTING CONTOUR |
| | PROPOSED CONTOUR |
| | PROPOSED 4" OR 6" CONCRETE 4000 PSI |
| | 1-1/2" TYPE SP 9.5 ACSC (MAXIMUM RECYCLE 20%) |
| | 6" LIMEROCK BASE (LBR 100) OR 6" CRUSHED CONCRETE (LBR 130) |
| | 12" STABILIZED SUBBASE (LBR 40) OR (FBV 75 PSI) |
| | DOWN LIGHT 150 WATT ON 20 FT POLE |

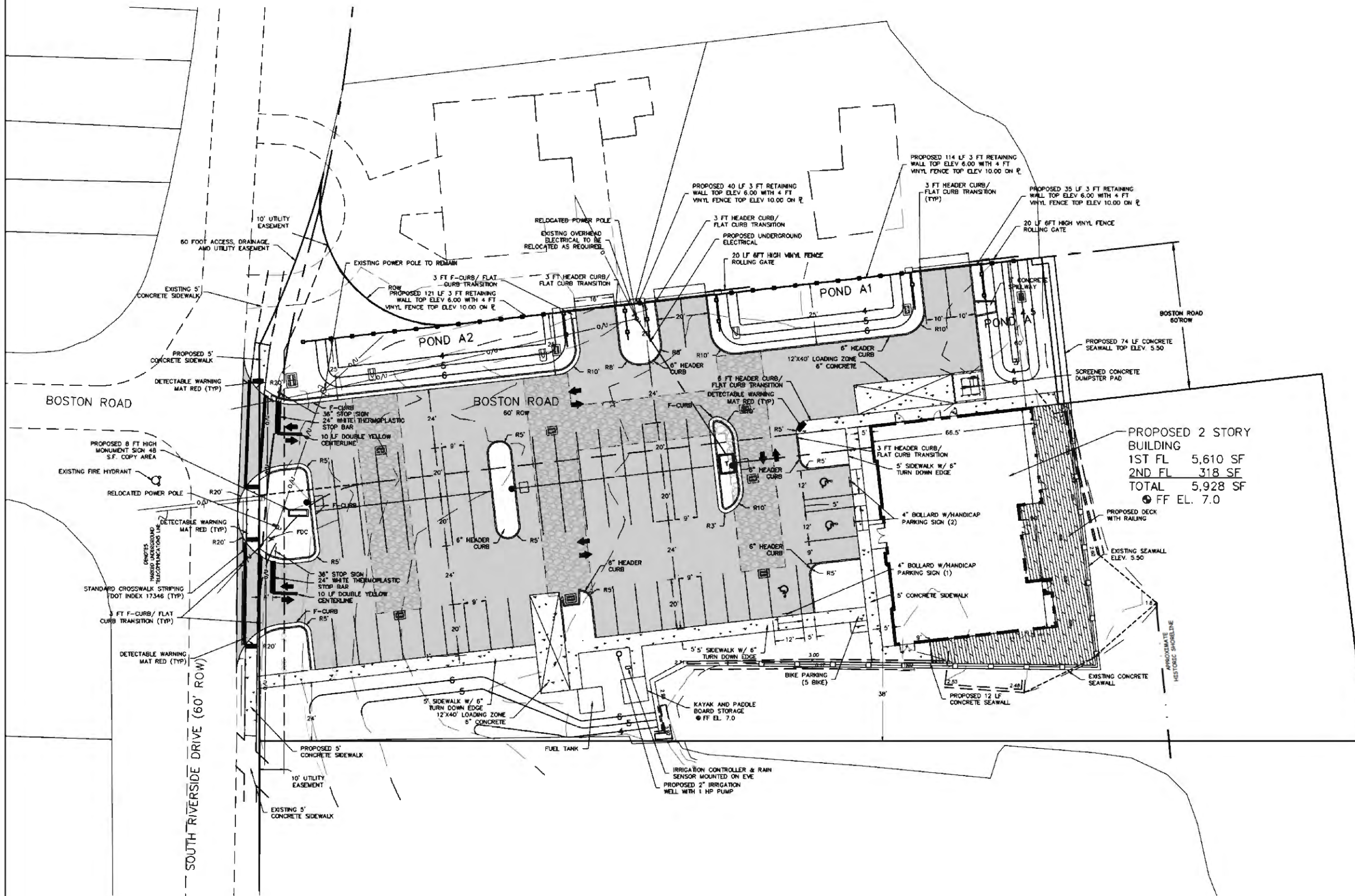

| NO. | DATE | DESCRIPTION | BY |
|-----|----------|------------------|-----|
| 5 | 4/12/19 | REVISED PER CITY | PKM |
| 4 | 3/15/19 | REVISED PER CITY | PKM |
| 3 | 3/3/19 | REVISED | PKM |
| 2 | 11/18/18 | REVISION | PKM |
| 1 | 10/11/18 | REVISION | PKM |

REVISIONS

PARKER MYNCHENBERG & ASSOCIATES, INC.
PROFESSIONAL ENGINEERS • LANDSCAPE ARCHITECTS
1729 RIDGEWOOD AVENUE HOLLY HILL, FLORIDA 32117
(386)677-6891 FAX(386)677-2114 E-MAIL: info@parkermynchenberg.com
CERTIFICATE OF AUTHORIZATION NUMBER: 00003818

SITE PLAN EDGEWATER MARINA

EDGEWATER • FLORIDA

| | |
|---------------------|--------------------------|
| FILE NO. 1752SP.DWG | DESIGNER: P. MYNCHENBERG |
| DATE: 7/17/2018 | CADD TECH: SLB |
| SCALE: 1" = 20'-0" | SHEET 4 OF 14 |

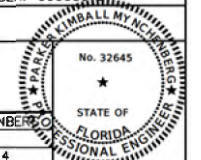

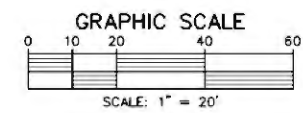

LEGEND

| | |
|--|---------------------|
| | EXISTING GRADE |
| | PROPOSED GRADE |
| | EXISTING CONTOUR |
| | PROPOSED CONTOUR |
| | PROPOSED DRAINAGE |
| | EXFILTRATION TRENCH |

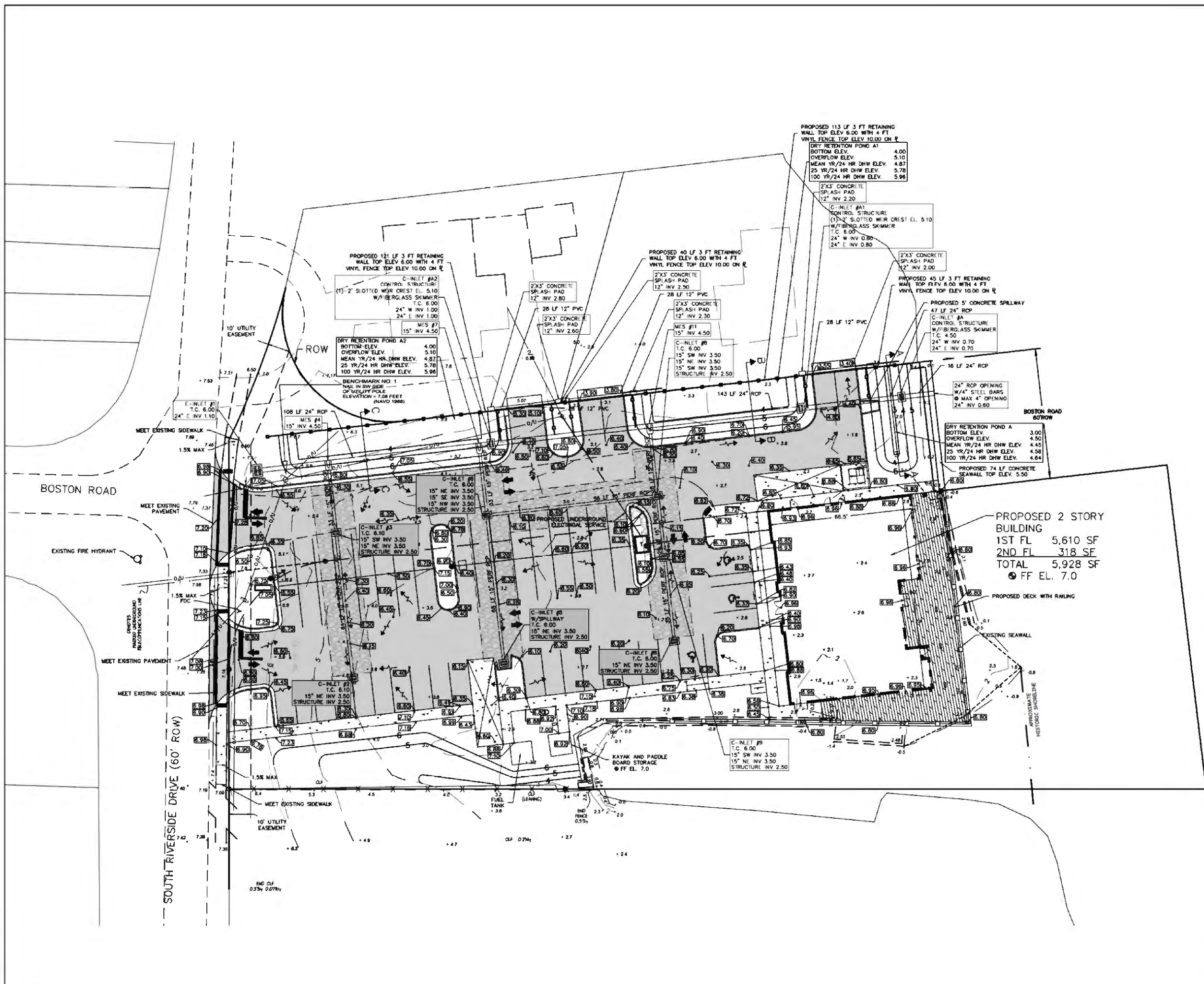

| NO. | DATE | DESCRIPTION | BY |
|-----|----------|------------------|-----|
| 5 | 4/12/19 | REVISED PER CITY | PKM |
| 4 | 3/15/19 | REVISED PER CITY | PKM |
| 3 | 3/3/19 | REVISED | PKM |
| 2 | 11/18/18 | REVISION | PKM |
| 1 | 10/11/18 | REVISION | PKM |

PARKER MYNCHENBERG & ASSOCIATES, INC.
PROFESSIONAL ENGINEERS • LANDSCAPE ARCHITECTS
1729 RIDGEWOOD AVENUE HOLLY HILL, FLORIDA 32117
(386)677-6891 FAX(386)677-2114 E-MAIL: info@parkermynchenberg.com
CERTIFICATE OF AUTHORIZATION NUMBER: 00003818

CIVIL PLAN
EDGEWATER MARINA

EDGEWATER • FLORIDA

FILE NO. 1752SP.DWG DESIGNER: P. MYNCHENBERG
DATE: 7/17/2018 CADD TECH: SLB
SCALE: 1" = 20'-0" SHEET 5 OF 14

STATE OF FLORIDA
PROFESSIONAL ENGINEER
No. 32645

Y:\Edgewater Marina - 17-325P.dwg 17:25:56 dms 4/12/2019 7:47 AM PKM, DUC. L. PGP DC3

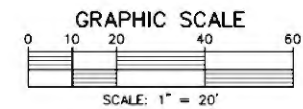
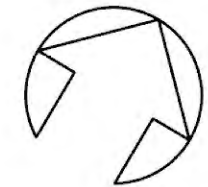

PROPOSED 2 STORY BUILDING
1ST FL 5,610 SF
2ND FL 318 SF
TOTAL 5,928 SF
FF EL. 7.0

NOTE:
CONTRACTOR TO VERIFY LOCATION AND SIZE OF
EXISTING WATER MAIN AND NOTIFY DESIGN ENGINEER.

| | | | |
|---|--------------------------|------------------|-----|
| 5 | 4/12/19 | REVISED PER CITY | PKM |
| 4 | 3/15/19 | REVISED PER CITY | PKM |
| 3 | 3/3/19 | REVISED | PKM |
| 2 | 11/18/18 | REVISION | PKM |
| 1 | 10/11/18 | REVISION | PKM |
| NO. | DATE | DESCRIPTION | BY |
| REVISIONS | | | |
| PARKER MYNCHENBERG & ASSOCIATES, INC. | | | |
| PROFESSIONAL ENGINEERS • LANDSCAPE ARCHITECTS | | | |
| 1729 RIDGEWOOD AVENUE HOLLY HILL, FLORIDA 32117 | | | |
| (386)677-6891 FAX(386)677-2114 E-MAIL: info@parkermynchenberg.com | | | |
| CERTIFICATE OF AUTHORIZATION NUMBER: 00003818 | | | |
| UTILITY PLAN | | | |
| EDGEWATER MARINA | | | |
| EDGEWATER • FLORIDA | | | |
| FILE NO. 1752SP.DWG | DESIGNER: P. MYNCHENBERG | | |
| DATE: 7/17/2018 | CADD TECH: SLB | | |
| SCALE: 1" = 20'-0" | SHEET 6 OF 14 | | |

\\cadd\pmy\17-325.dwg (1752SP.DWG) 4/12/2019 7:51:13 AM PML DWG TO PDF K3

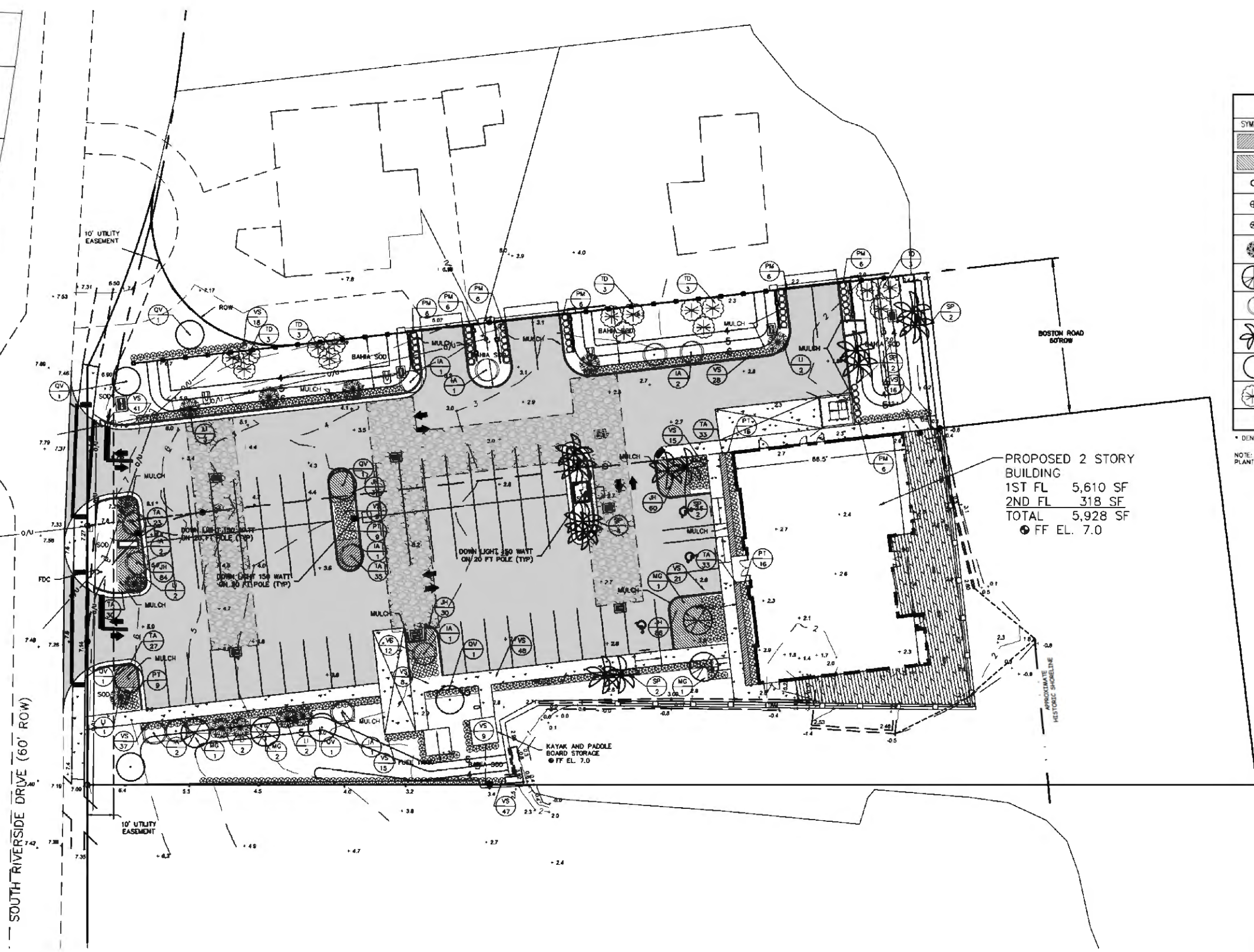
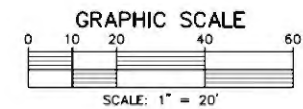
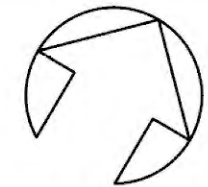

PROPOSED 2 STORY BUILDING
1ST FL 5,610 SF
2ND FL 318 SF
TOTAL 5,928 SF
FF EL. 7.0

| PLANT LIST | | | | |
|------------|------|------|--|--------------------|
| SYMBOL | ABB. | QTY. | BOTANICAL NAME | COMMON NAME |
| | TA | 151 | TRACHELOSPERMUM ASIATICUM | ASIAN JASMINE |
| | JH | 297 | JUNIPERUS HORIZONTALIS | CREeping JUNPER |
| | PM | 42 | PODOCARPUS MACROPHYLLA | YEW PODOCARPUS |
| | PT | 62 | PITTOSPORUM TOBIRA | GREEN PITTOSPORUM |
| | VS | 298 | VIBURNUM SUSPENSUM | SANDANKWA VIBURNUM |
| | LI | 12 | LAGERSTROEMIA INDICA | CREPE MYRTLE |
| | MG | 4 | MAGNOLIA GRANDIFLORA | SOUTHERN MAGNOLIA |
| | IA | 11 | ILEX ATTENUATA | EAST PALATKA HOLLY |
| | SP | 12 | SABAL PALMETTO | SABAL PALM |
| | OV | 6 | QUERCUS VIRGINIANA | LIVE OAK |
| | TD | 15 | TAXODIUM DISTICHUM | BALD CYPRESS |
| | SOD | | ST. AUGUSTINE "FLORATAM" SOLID SOD (SQ. FT.) | |

* DENOTES SPECIMEN TREES

NOTE:
PLANT SPECIFIED SIZE SHALL GOVERN OVER THE GALLONAGE INDICATED

| | |
|-------------------|-------------------|
| TREES REQUIRED = | TREES PROVIDED = |
| 23 SPECIMEN TREES | 23 SPECIMEN TREES |
| 23 TREES | 23 TREES |
| 402 SHRUBS | 402 SHRUBS |

| NO. | DATE | DESCRIPTION | BY |
|-----|----------|------------------|-----|
| 5 | 4/12/19 | REVISED PER CITY | PKM |
| 4 | 3/15/19 | REVISED PER CITY | PKM |
| 3 | 3/3/19 | REVISED | PKM |
| 2 | 11/18/18 | REVISION | PKM |
| 1 | 10/11/18 | REVISION | PKM |

PARKER MYNCHENBERG & ASSOCIATES, INC.
PROFESSIONAL ENGINEERS • LANDSCAPE ARCHITECTS
1729 RIDGEWOOD AVENUE HOLLY HILL, FLORIDA 32117
(386)677-6891 FAX (386)677-2114 E-MAIL: info@parkermynchenberg.com
CERTIFICATE OF AUTHORIZATION NUMBER: 00003818

LANDSCAPE PLAN
EDGEWATER MARINA

EDGEWATER • FLORIDA

FILE NO. 1752SP.DWG
DATE: 7/17/2018
SCALE: 1" = 20'-0"

DESIGNER: P. MYNCHENBERG
CADD TECH: SLB
SHEET 7 OF 14

STATE OF FLORIDA
LANDSCAPE ARCHITECT
No. 0001553

LANDSCAPE NOTES

- THE CONTRACTOR SHALL BE RESPONSIBLE FOR ALL MATERIALS AND WORK CALLED FOR IN THE LANDSCAPE PLAN. THE PLANT LIST QUANTITIES SHALL BE USED AS A GUIDE ONLY. THE CONTRACTOR SHALL VERIFY ALL QUANTITIES AND REPORT ANY DISCREPANCIES.
- ALL PLANT BEDS AND ALL EXISTING AND PROPOSED PARKING LOT ISLANDS SHALL BE DRESSED WITH 2" 3" MINIMUM SHREDDED CYPRESS MULCH.
- THE CONTRACTOR SHALL BE WHOLLY RESPONSIBLE FOR STABILITY AND PLUMB CONDITION OF ALL PLANTS AND SHALL BE LEGALLY LIABLE FOR ANY DAMAGE CAUSED BY INSTABILITY OF PLANT MATERIALS.
- THE CONTRACTOR SHALL DISPOSE OF STUMPS AND MAJOR ROOTS OF ALL PLANTS TO BE REMOVED.
- THE LANDSCAPE CONTRACTOR SHALL BECOME THOROUGHLY FAMILIAR WITH ALL OTHER WORK TO BE DONE ON SITE, PRIOR TO LANDSCAPE INSTALLATION.
- THE CONTRACTOR SHALL INSURE ADEQUATE VERTICAL DRAINAGE IN ALL PLANT BEDS. TEST HOLES FOR THE VISUAL INSPECTION OF DRAINAGE SHALL BE DUG PRIOR TO INSTALLATION OF ANY PLANTS. THE CONTRACTOR SHALL AMEND POOR DRAINAGE UNTIL ACCEPTABLE FOR PLANT SURVIVABILITY.
- ALL PLANT BEDS TO BE TWICE THE WIDTH OF THE ROOT BALL AND SHALL BE BACKFILLED WITH 50% SAND, 30% PEAT, 20% COW MANURE UNIFORMLY MIXED.
- THE CONTRACTOR SHALL REPLACE ALL PLANTS WHICH ARE NOT IN A HEALTHY GROWING CONDITION PRIOR TO ACCEPTANCE. ALL PLANTS SHALL BE MAINTAINED AND GUARANTEED BY THE CONTRACTOR FOR A PERIOD OF 90 DAYS FOLLOWING ACCEPTANCE BY THE OWNER. ANY PLANTS FOUND NOT TO BE IN A HEALTHY GROWING CONDITION AT THE END OF THE GUARANTEE PERIOD SHALL BE REPLACED AT NO ADDITIONAL COST TO THE OWNER.
- SOD SHALL BE STRONG, SOLID SOD PLACED EVENLY AND WITHOUT GAPS BETWEEN PIECES. GROUND SHALL BE THOROUGHLY WETTED BEFORE PLACING SOD. SOD SHALL BE PLACED TO LIMITS SHOWN AND TO THE EXTENT OF DAMAGED EXISTING SOD. EXISTING GROUND SHALL BE STRIPPED BEFORE PLACING NEW SOD.
- ALL TREES AND SHRUBS TO BE PLANTED NO LOWER THAN PROPOSED GRADE.
- THE TWO AREAS SHOWN HEREON ON THIS DRAWING AND ON THE SITE DEVELOPMENT PLAN ARE LABELED TO REMAIN NATURAL. NO TREES ARE TO BE REMOVED FROM THESE AREAS WITHOUT APPROVAL OF THE OWNER AND CITY.
- CLEARING PROCEDURE: THE OWNER OR DEVELOPER IS RESPONSIBLE FOR INSURING THAT ALL POSSIBLE MEASURES ARE TAKEN DURING THE CLEARING PROCESS TO AVOID DAMAGE TO TREES AND VEGETATION DESIGNATED TO REMAIN AFTER CONSTRUCTION. THIS INCLUDES USE OF HAND LABOR RATHER THAN LARGE MACHINERY WHERE NECESSARY TO PROTECT TREES TO BE PRESERVED. ALL FELLE MATERIAL SHALL BE PROMPTLY AND CAREFULLY REMOVED FROM THE SITE IN ORDER TO AVOID POTENTIAL DAMAGE TO REMAINING TREES AND VEGETATION AND THE HARBORING OF INSECTS AND RODENTS.
- ALL PLANT MATERIALS SHALL BE FLORIDA NO. 1 GRADE OR BETTER, ACCORDING TO THE CURRENT GRADES AND STANDARDS FOR NURSERY PLANTS, STATE OF FLORIDA, DEPARTMENT OF AGRICULTURE, TALLAHASSEE, EXCEPT WHERE IN THE DISCRETION OF THE ENFORCEMENT OFFICIAL NATURAL VEGETATION IS ADEQUATE TO PROVIDE THE NECESSARY VISUAL SCREENING.
 - GROUND COVERS, GROUND COVERS MAY INCLUDE ANY PLANT MATERIALS THAT REACH AN AVERAGE HEIGHT OF NOT MORE THAN 12 INCHES. GROUND COVERS MUST PRESENT A FINISHED APPEARANCE AND PROVIDE REASONABLE COVERAGE AT TIME OF PLANTING.
 - LAWN GRASS, GRASSED AREAS SHALL BE PLANTED WITH ST. AUGUSTINE FLORIDANA OR EQUAL APPROVED BY OWNER.

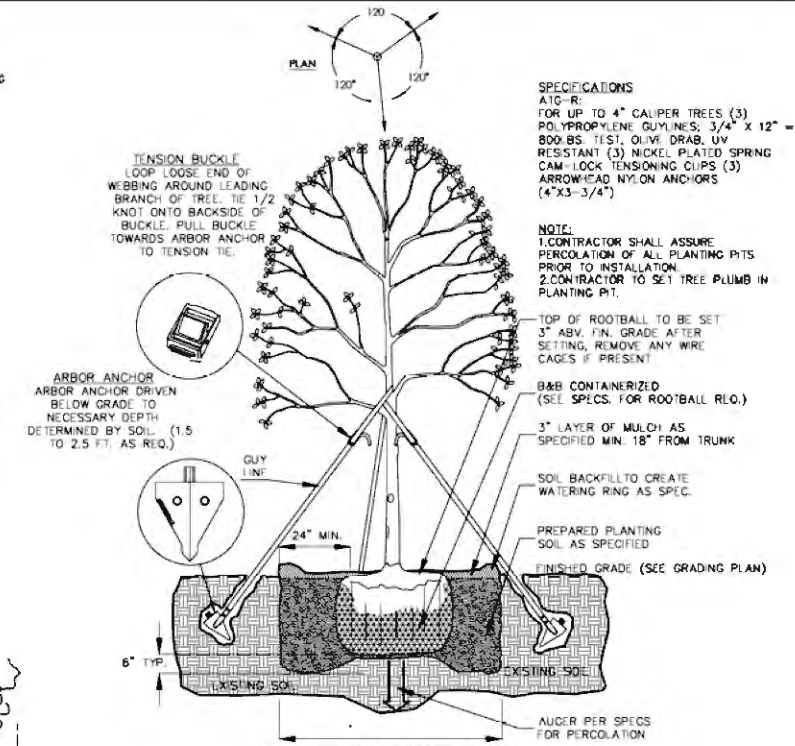
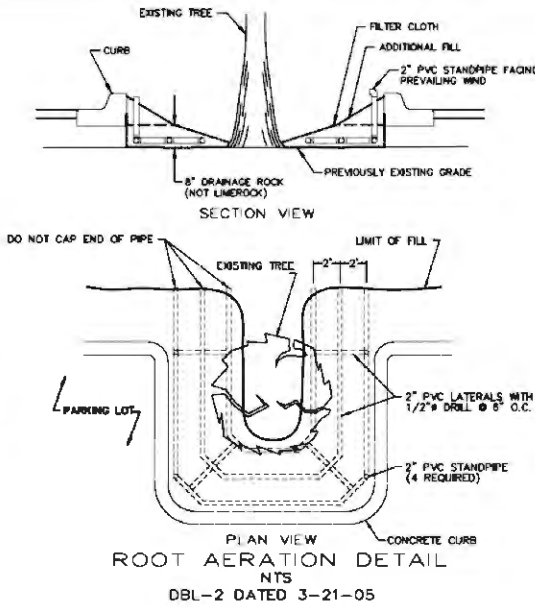
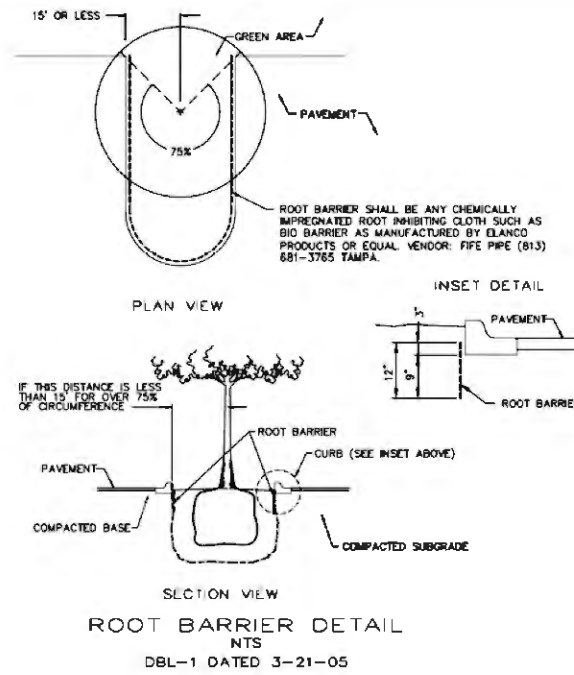

TREE PLANTING & GUY DETAILS

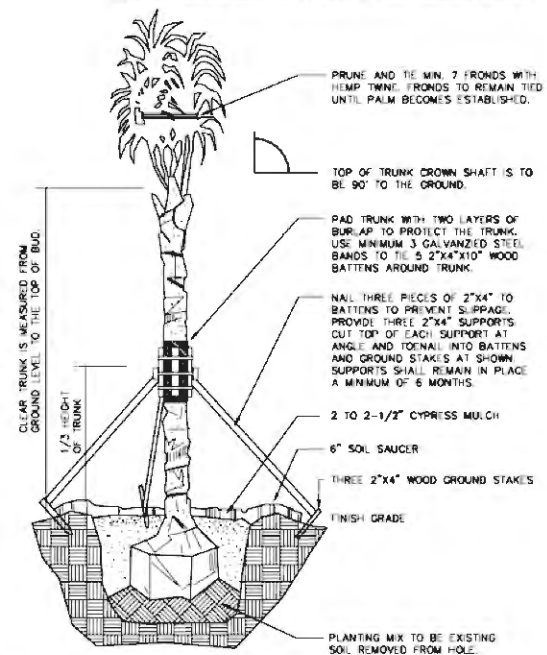

TYP. PALM TREE PLANTING DETAIL

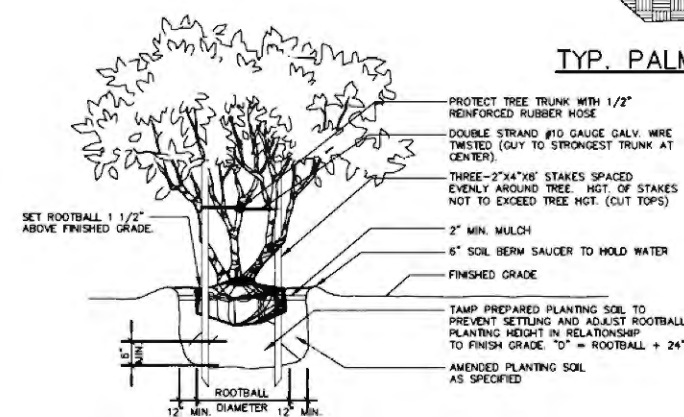

- CONTRACTOR SHALL ASSURE PERCOLATION OF ALL PLANTING BEDS / PITS PRIOR TO INSTALLATION.
- ALL STAKING AND CROSS MEMBERS TO BE PRESSURE TREATED PINE.
- FINAL TREE STAKING DETAILS AND PLACEMENT TO BE APPROVED BY THE OWNER.

TYPICAL MULTI-TRUNK TREE

- CUTS ARE TO BE MADE CLEANLY WITH A SHARP ROOT PRUNING TOOL (SUCH AS A DOSCO OR VERMEER ROOT PRUNER).
- INSTALL ORANGE PLASTIC MESH TREE BARRIER, WITH REBAR SUPPORTS, AT POINT OF PRUNING AND CONTINUE COMPLETELY AROUND TREE, PROTECTING THE AREA WITHIN THE DROPLINE (EXTENT OF OUTER BRANCHES).
- ROOT PRUNING PROCEDURE MUST BE DONE AND INSPECTED PRIOR TO ISSUANCE OF A BUILDING PERMIT OR GRADING AND FILLING PERMIT.

ROOT PRUNING DETAIL NTS DBL-3 DATED 3-21-05

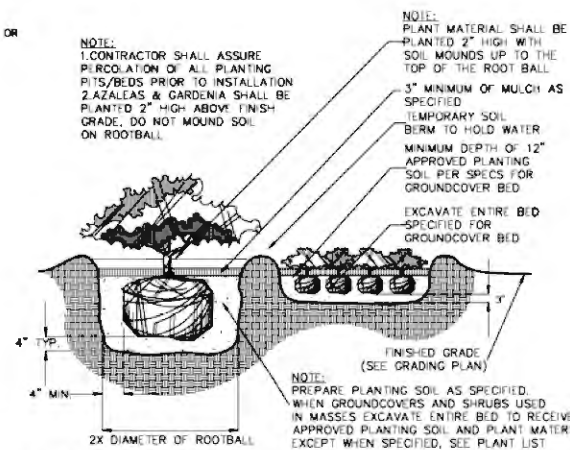

SHRUB AND GROUND COVER PLANTING DETAIL

SODDING, SEEDING, & MULCHING NOTES

- SCOPE OF WORK THE WORK IN THIS SECTION CONSISTS OF FURNISHING AND COMPLETELY INSTALLING SOD, OR SEED AND MULCH OVER THE LIMITS CALLED FOR ON THE CONSTRUCTION DRAWINGS. AT A MINIMUM ALL WORK SHALL MEET THE MINIMUM SPECIFICATIONS OF THE FOOT STANDARD SPECIFICATIONS FOR ROAD AND BRIDGE CONSTRUCTION, LATEST EDITION, AS OUTLINED IN SECTIONS 570 (GRASSING BY SEEDING) AND 575 (SODDING). IN ADDITION, ALL WORK SHALL MEET THE MINIMUM REQUIREMENTS OF THE CITY.

- MATERIALS GRASS SEED SHALL BE A MIXTURE OF:

| | |
|--------------------------|-----|
| PENSACOLA BAHIA | 50% |
| (USE 50% SCARIFIED SEED) | |
| MULLED BERMUDA | 25% |
| BROWN TOP MILLET | 25% |

IN THE FALL AND WINTER MONTHS, AND WITH THE APPROVAL OF THE CITY, ANNUAL RYE GRASS SHALL BE SUBSTITUTED IN EQUAL AMOUNTS FOR THE BROWN TOP MILLET SEED. SHALL BE PRE-MIXED BY A SEED COMPANY TO THE PERCENTAGES DESCRIBED ABOVE, WITH CERTIFICATION FROM THE SUPPLIER PROVIDED TO THE CITY'S DESIGNATED PROJECT LANDSCAPE INSPECTOR PRIOR TO USE.

MULCH USED SHALL BE STRAW OR HAY CONSISTING OF OATS, RYE, OR WHEAT STRAW, OR OF PANGOLA, PEANUT, COASTAL BERMUDA, OR BAHIA GRASS. HAY MULCH SHALL BE FREE FROM UNDESIRABLE WEED AND OTHER UNDESIRABLE GRASS.

- METHODS GRASSING SHALL BE DONE IMMEDIATELY UPON COMPLETION OF THE FINE GRADING OPERATION. HOWEVER, NO SEEDING SHALL BE DONE WHEN THE GROUND IS FROZEN OR UNDULY WET. THE RATE OF SPREAD FOR THE SEED MATERIAL SHALL BE ONE HUNDRED AND THIRTY (130) POUNDS PER ACRE.

APPROXIMATELY ONE INCH (1"), LOOSE THICKNESS, OF MULCH MATERIAL SHALL BE APPLIED UNIFORMLY OVER THE SEEDING AREAS (APPROXIMATELY ONE AND ONE-HALF (1-1/2) BALES PER 1000 SQUARE FEET). THE MULCH MATERIAL SHALL BE CUT INTO THE SOIL WITH A DISC HARROW OR OTHERWISE ANCHORED DOWN, UNDER PROPER CIRCUMSTANCES, CONTRACTOR MAY REQUEST OPTION TO INSTALL HYDRO-SEEDING SUBJECT TO THE APPROVAL OF THE PROJECT LANDSCAPE ARCHITECT AND THE CITY.

| NO. | DATE | DESCRIPTION | BY |
|-----|----------|------------------|-----|
| 5 | 4/12/19 | REVISED PER CITY | PKM |
| 4 | 3/15/19 | REVISED PER CITY | PKM |
| 3 | 3/3/19 | REVISED | PKM |
| 2 | 11/18/18 | REVISION | PKM |
| 1 | 10/11/18 | REVISION | PKM |

PARKER MYNCHENBERG & ASSOCIATES, INC.
 PROFESSIONAL ENGINEERS * LANDSCAPE ARCHITECTS
 1729 RIDGEWOOD AVENUE HOLLY HILL, FLORIDA 32117
 (386)677-6891 FAX(386)677-2114 E-MAIL: info@parkermynchenberg.com
 CERTIFICATE OF AUTHORIZATION NUMBER: 00003910

| LANDSCAPE DETAILS | |
|--------------------------|---------------------|
| EDGEWATER MARINA | |
| EDGEWATER * FLORIDA | FILE NO. 1752UD.DWG |
| DESIGNER: P. MYNCHENBERG | DATE: 7/17/2018 |
| CADD TECH: SLB | SCALE: NONE |
| SHEET 8 OF 14 | |

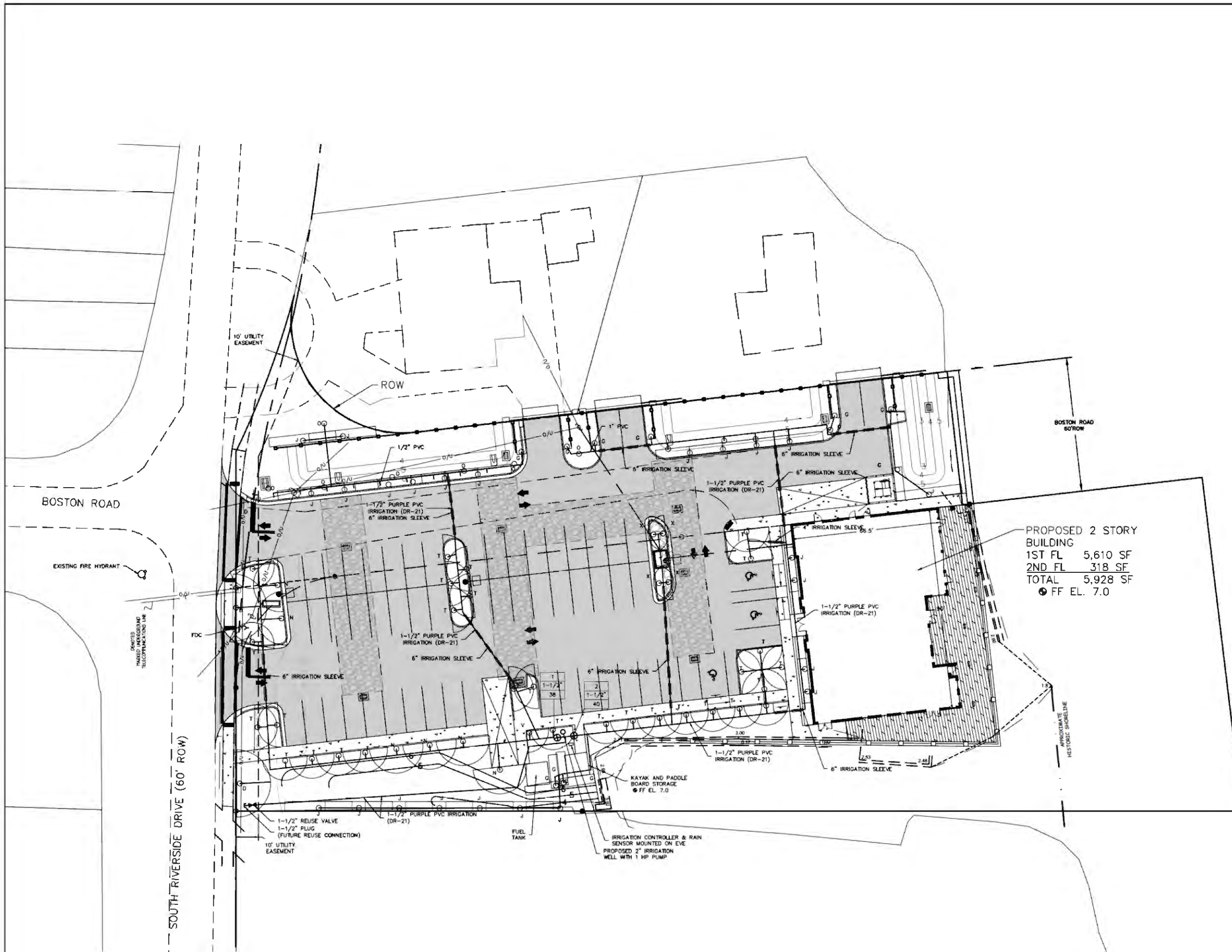
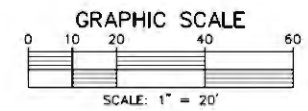
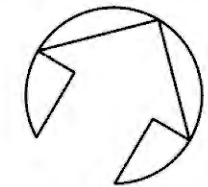

PROPOSED 2 STORY
BUILDING
1ST FL 5,610 SF
2ND FL 318 SF
TOTAL 5,928 SF
• FF EL. 7.0

| | | | |
|-----|----------|------------------|-----|
| 5 | 4/12/19 | REVISED PER CITY | PKM |
| 4 | 3/15/19 | REVISED PER CITY | PKM |
| 3 | 3/3/19 | REVISED | PKM |
| 2 | 11/18/18 | REVISION | PKM |
| 1 | 10/11/18 | REVISION | PKM |
| NO. | DATE | DESCRIPTION | BY |

REVISIONS

PARKER MYNCHENBERG & ASSOCIATES, INC.
PROFESSIONAL ENGINEERS • LANDSCAPE ARCHITECTS
1729 RIDGEWOOD AVENUE HOLLY HILL, FLORIDA 32117
(386)677-6891 FAX(386)677-2114 E-MAIL: info@parkermynchenberg.com
CERTIFICATE OF AUTHORIZATION NUMBER: 00003818

IRRIGATION PLAN
EDGEWATER MARINA

EDGEWATER • FLORIDA

FILE NO. 1752SP.DWG DESIGNER: P. MYNCHENBERG
DATE: 7/17/2018 CADD TECH: SLB
SCALE: 1" = 20'-0" SHEET 9 OF 14

STATE OF FLORIDA
LANDSCAPE ARCHITECT
No. 0001553

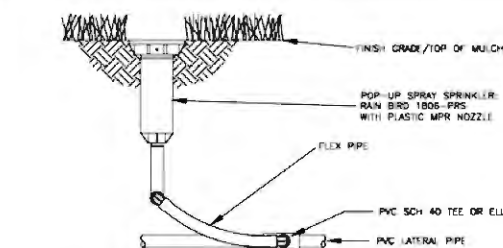

MODEL 1806-PRS 6" POP-UP
FIXED-SPRAY (MPR SERIES), FLEX PIPE, PRESSURE REGULATING

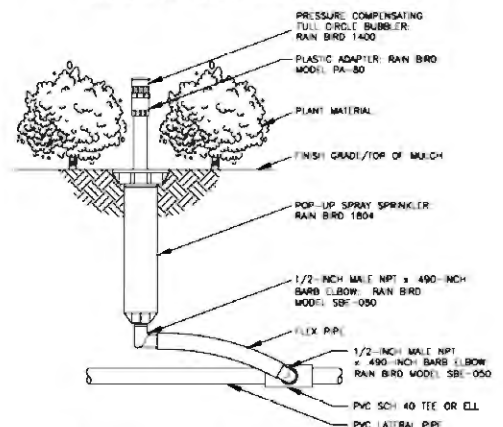

MODEL 1812-PRS 12" POP-UP
FIXED-SPRAY (MPR SERIES), FLEX PIPE, PRESSURE REGULATING

| RAIN BIRD MPR SERIES NOZZLE SELECTION CHART | | | | | | | | | |
|---|--------|--------|--------|--------|---------------|--|--|--|--|
| SYM | SPEC | P.S.I. | G.P.M. | RADIUS | PATTERN | | | | |
| A | 15I | 30 | 3.7 | 15' | FULL | | | | |
| B | 15Q | 30 | 2.78 | 15' | THREE QUARTER | | | | |
| C | N/A | - | - | - | N/A | | | | |
| D | 15H | 30 | 1.85 | 15' | HALF | | | | |
| E | 15I | 30 | 1.23 | 15' | THIRD | | | | |
| F | 15Q | 30 | 0.92 | 15' | QUARTER | | | | |
| G | 15ST | 30 | 0.61 | 4'x15' | END STRIP | | | | |
| H | 1805ST | 30 | 1.21 | 4'x30' | CENTER STRIP | | | | |
| I | 1805ST | 30 | 1.21 | 4'x30' | SIDE STRIP | | | | |
| J | 12I | 30 | 2.6 | 12' | FULL | | | | |
| K | 12Q | 30 | 1.95 | 12' | THREE QUARTER | | | | |
| L | 12H | 30 | 1.3 | 12' | HALF | | | | |
| M | N/A | - | - | - | N/A | | | | |
| N | 12H | 30 | 0.50 | 5' | BUBBLER | | | | |
| O | 50-B | 30 | 0.87 | 12' | THIRD | | | | |
| P | 12Q | 30 | 0.65 | 12' | QUARTER | | | | |
| R | 10I | 30 | 1.56 | 10' | FULL | | | | |
| S | 10H | 30 | 0.79 | 10' | HALF | | | | |
| T | 10Q | 30 | 0.39 | 10' | QUARTER | | | | |
| V | 8I | 30 | 1.05 | 8' | FULL | | | | |
| W | 8H | 30 | 0.52 | 8' | HALF | | | | |
| X | 8Q | 30 | 0.35 | 8' | THIRD | | | | |
| Y | 8I | 30 | 0.26 | 8' | QUARTER | | | | |
| Z | 5I | 30 | 0.41 | 5' | FULL | | | | |
| 5I | 5H | 30 | 0.20 | 5' | HALF | | | | |
| 5Q | 5Q | 30 | 0.13 | 5' | THIRD | | | | |
| 5Q | 5Q | 30 | 0.10 | 5' | QUARTER | | | | |

| 5500 NOZZLE PERFORMANCE DATA CHART | | | | |
|------------------------------------|-----|------|--------|--|
| NOZZLE NO. | PSI | GPM | RADIUS | |
| 2 | 40 | 1.8 | 37' | |
| 3 | 40 | 2.7 | 39' | |
| 4 | 40 | 2.9 | 41' | |
| 5 | 40 | 3.5 | 41' | |
| 6 | 40 | 4.8 | 45' | |
| 8 | 40 | 6.4 | 45' | |
| 10 | 40 | 7.5 | 41' | |
| 12 | 40 | 10.1 | 39' | |

| 5500 SHORT RADIUS NOZZLE PERFORMANCE DATA CHART | | | | |
|---|-----|-----|--------|--|
| NOZZLE NO. | PSI | GPM | RADIUS | |
| 185 | 40 | 1.5 | 19' | |
| 225 | 40 | 1.6 | 21' | |
| 265 | 40 | 1.9 | 25' | |
| 305 | 40 | 1.8 | 29' | |

IRRIGATION LEGEND

- RAIN BIRD 1800 SERIES - SPRAY HEAD ON RISER, INSTALLED AS SHOWN, SEE NOZZLE CHART
- RAIN BIRD 1806-PRS SERIES - 6" POP-UP SPRAY HEAD, INSTALLED AS SHOWN, SEE NOZZLE CHART
- RAIN BIRD MODEL 5500 SERIES SPRINKLER - GEAR DRIVE, FULLY ADJUSTABLE
- RAIN BIRD PEB OR PESB SERIES - ELECTRIC CONTROL VALVE, INSTALLED IN VALVE BOX
- DENOTES PROPOSED VALVE (SIZE AS SHOWN)
- DENOTES PROPOSED IRRIGATION MAIN, SCH. 40 (SIZE AS SHOWN)
- DENOTES PROPOSED IRRIGATION LATERAL, SCH. 40 (SIZE AS SHOWN)
- P.V.C. SLEEVE SIZE AS SHOWN
- DENOTES PROPOSED RAIN SENSOR, RAIN BIRD RSD SERIES
- DENOTES PROPOSED RAIN BIRD ESP-MC SERIES CONTROLLER

| VALVE KEY ID-BOX | |
|------------------|--------------------|
| 1 | SIZE OF VALVE |
| 1-1/2" | GALLONS PER MINUTE |
| 35 | |

SPECIFIC IRRIGATION NOTES

- IRRIGATION SPRAY HEADS SHALL BE PRESSURE REGULATING.
- SYSTEM SUPPLY REQUIREMENTS ARE: 40 GPM @ 40 PSI AT WATER SOURCE. CONTRACTOR SHALL NOTIFY LANDSCAPE ARCHITECT IF DESIGN FLOW RATE AND PRESSURE DOES NOT EXIST.
- LATERAL PIPES SHALL BE SIZED SUCH THAT THE WATER VELOCITY DOES NOT EXCEED 5 FEET/SECOND. CONTRACTOR SHALL APPLY THE FOLLOWING TABLE:

| PIPE SIZE (IN) | FLOW |
|----------------|----------|
| 1/2" | <8 GPM |
| 3/4" | <10 GPM |
| 1" | <15 GPM |
| 1 1/2" | <26 GPM |
| 2" | <36 GPM |
| 2 1/2" | <50 GPM |
| 3" | <80 GPM |
| 4" | <120 GPM |
| 6" | <200 GPM |

SPRINKLERS: PRESSURE COMPENSATING FULL-CIRCLE BUBBLER

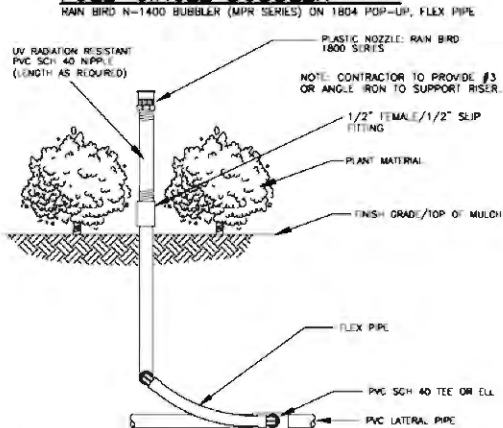

MODEL 1800 NOZZLE ON RISER
FIXED SPRAY, FLEX PIPE

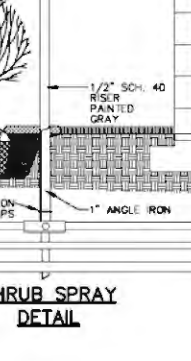
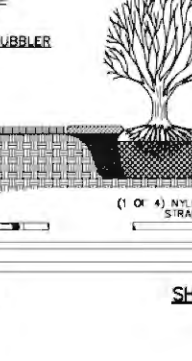
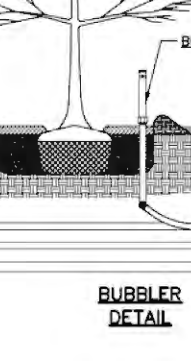
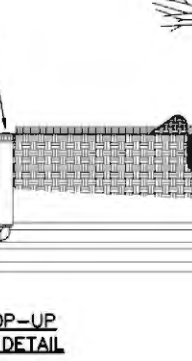
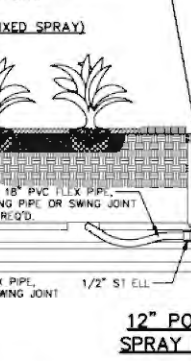
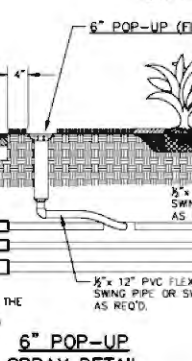
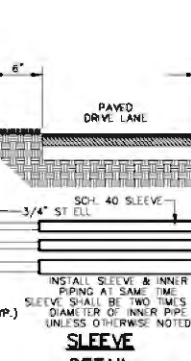
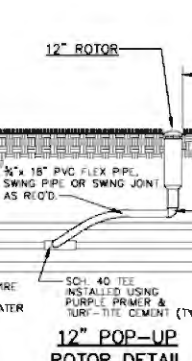
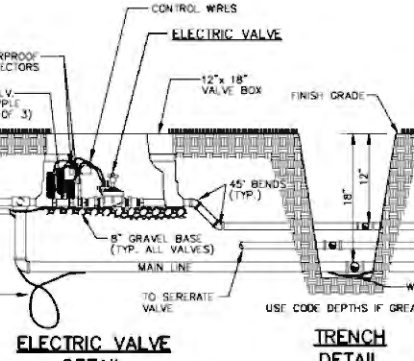
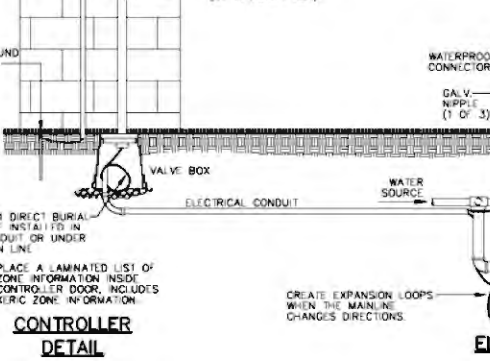
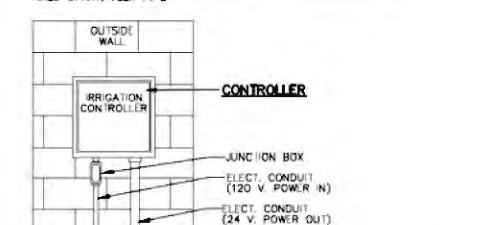

| | | | |
|----|----------|------------------|-----|
| 5 | 4/12/19 | REVISED PER CITY | PKM |
| 4 | 3/15/19 | REVISED PER CITY | PKM |
| 3 | 3/3/19 | REVISED | PKM |
| 2 | 11/18/18 | REVISION | PKM |
| 1 | 10/11/18 | REVISION | PKM |
| NO | DATE | DESCRIPTION | BY |

REVISIONS

PARKER MYNCHENBERG & ASSOCIATES, INC.
PROFESSIONAL ENGINEERS * LANDSCAPE ARCHITECTS
1729 RIDGEWOOD AVENUE HOLLY HILL, FLORIDA 32117
(386)677-6891 FAX(386)677-2114 E-MAIL: info@parkermynchenberg.com
CERTIFICATE OF AUTHORIZATION NUMBER: 00003910

IRRIGATION DETAILS
EDGEWATER MARINA

EDGEWATER * FLORIDA

FILE NO. 1752LID.DWG DESIGNER: P. MYNCHENBERG
DATE: 7/17/2018 CADD TECH: SLB
SCALE: NONE SHEET 10 OF 14

STATE OF FLORIDA
LANDSCAPE ARCHITECT

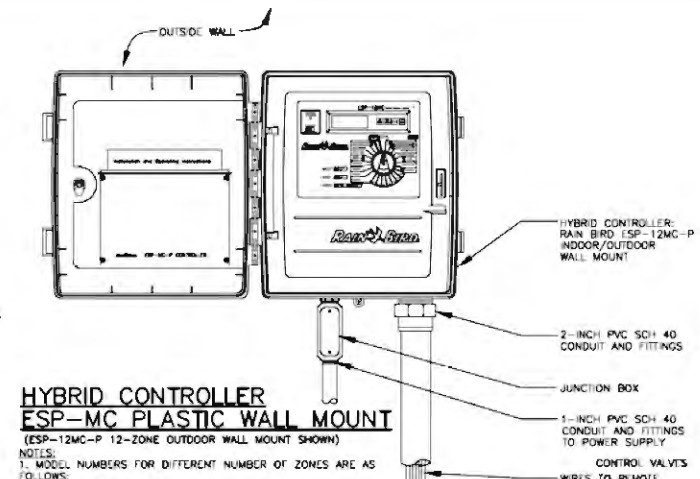

HYBRID CONTROLLER ESP-MC PLASTIC WALL MOUNT
(ESP-12MC-P 12-ZONE OUTDOOR WALL MOUNT SHOWN)
NOTES:
1. MODEL NUMBERS FOR DIFFERENT NUMBER OF ZONES ARE AS FOLLOWS:
* ESP-8MC-P FOR 8-ZONE
ESP-16MC-P FOR 16-ZONE
ESP-24MC-P FOR 24-ZONE
ESP-32MC-P FOR 32-ZONE
ESP-40MC-P FOR 40-ZONE
2. FOR INDOOR WALL MOUNT, JUST CHANGE NOTATION ON DETAIL.
3. CONTRACTOR MAY SUBSTITUTE STEEL WALL MOUNT IN LIEU OF PLASTIC WALL MOUNT AT NO ADDITIONAL COST TO THE OWNER.

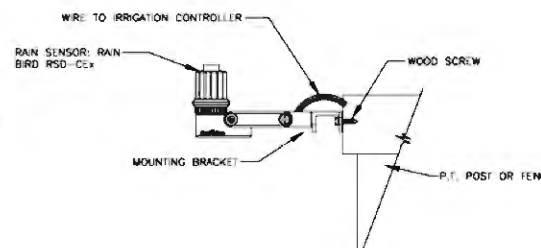

MODEL RSD-CEX POST/FENCE MOUNTING

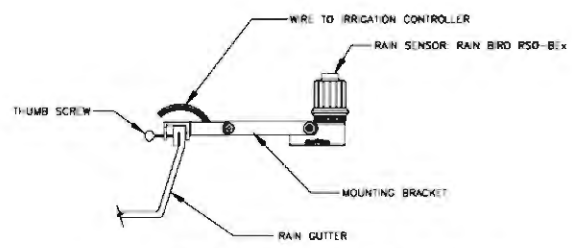

MODEL RSD-BEX GUTTER MOUNTING

RAIN SENSOR MOUNTING DETAILS

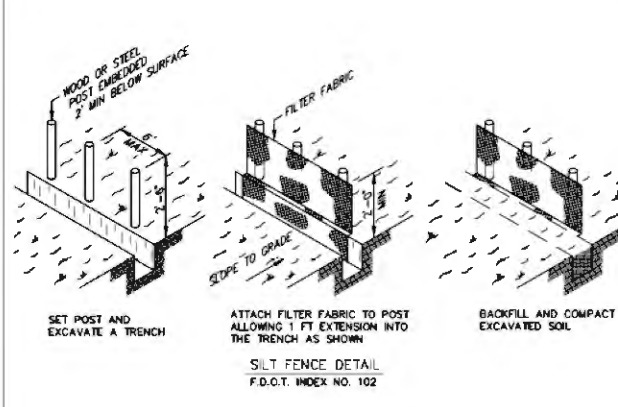
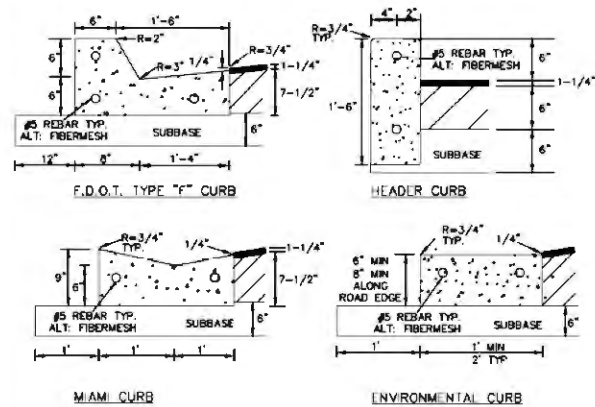

NOTES:

1. MATERIALS, CONSTRUCTION METHODS AND MAINTENANCE SHALL BE IN ACCORDANCE WITH THE FLORIDA DEPARTMENT OF TRANSPORTATION STANDARD SPECIFICATIONS AND DESIGN STANDARDS CURRENT EDITION.
2. CONTRACTOR SHALL PROVIDE SILT FENCES AND MAY BALES AT ALL STORMWATER DISCHARGE POINTS FOR EROSION CONTROL AND SEDIMENT CONTROL DURING CONSTRUCTION.
3. CONTRACTOR SHALL ROUGH GRADE STORMWATER SWALES AND RETENTION AREAS PRIOR TO CONSTRUCTION OF SITE IMPROVEMENTS.
4. CONTRACTOR SHALL MEET ALL PERMIT CONDITIONS AS ESTABLISHED BY THE CITY AND ALL OTHER APPLICABLE AGENCIES, INCLUDING BUT NOT LIMITED TO COUNTY, FDOT, AND THE SURROUNDING.

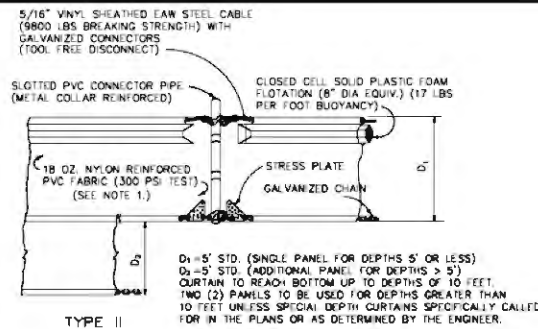

FLOATING TURBIDITY BARRIERS

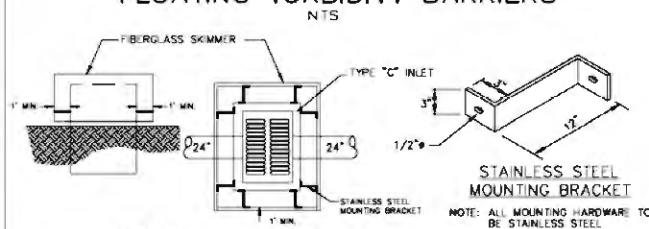

FIBERGLASS SKIMMER DETAIL

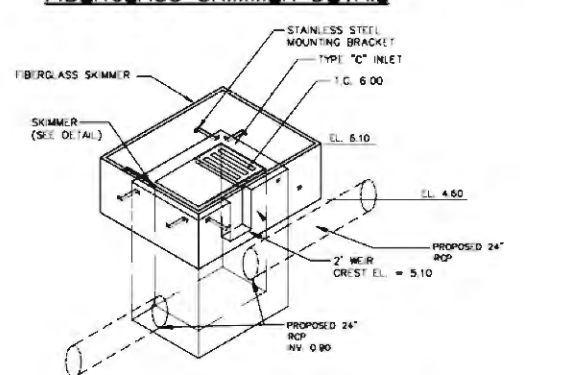

PROPOSED CONTROL STRUCTURE #A2

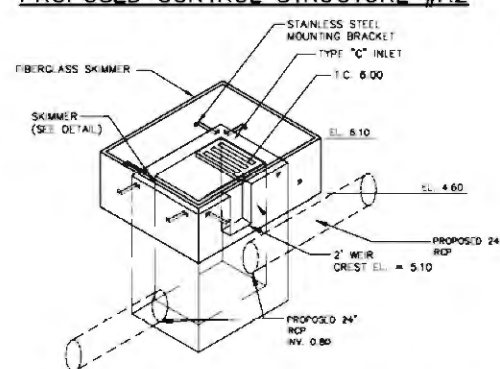

PROPOSED CONTROL STRUCTURE #A1

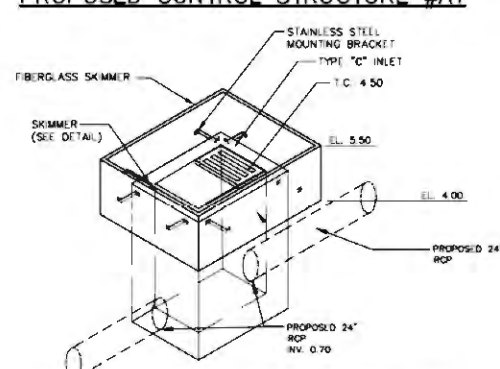

PROPOSED CONTROL STRUCTURE #A

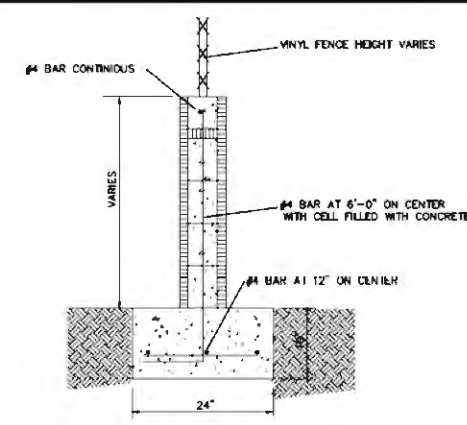

RETAINING WALL DETAIL

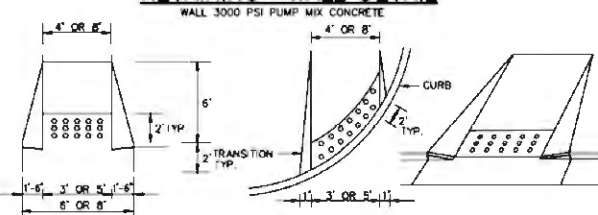

NOTES:

1. RAMP LOCATIONS ARE TO BE COORDINATED WITH AND IN CONFORMANCE WITH CROSSWALK MARKING DETAILS SHOWN IN THE PLANS.
2. CURBED RAMPS SHALL HAVE FLARED SIDES WITH A MAXIMUM SLOPE OF 12:1.
3. RAMPS SHALL HAVE A DETECTABLE WARNING SURFACE AS SHOWN.
4. RAMPS ARE TO BE CONSTRUCTED AT ALL LOCATIONS SHOWN IN THE PLANS EVEN WHEN A SIDEWALK IS NOT CONSTRUCTED CONCURRENTLY.
5. NO CURB TRANSITION IS NEEDED FOR MIAMI CURBS.
6. ALL RAMPS SHALL BE CONSTRUCTED IN ACCORDANCE WITH FDOT INDEX NO. 304 AND HANDICAPPED ACCESSIBILITY REQUIREMENTS IN ACCORDANCE WITH THE AMERICAN DISABILITIES ACT.

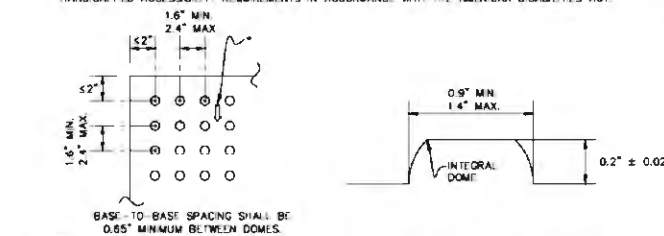

NOTES:

1. ON RAMPS THAT ARE PERPENDICULAR WITH THE CURB LINE, THE DOME PATTERN SHALL BE IN-LINE WITH THE DIRECTION OF TRAVEL. ON RAMPS INTERSECTING CURBS ON A RADIUS, THE DOME PATTERN SHALL BE IN-LINE WITH THE DIRECTION OF TRAVEL TO THE EXTENT PRACTICAL.

DETECTABLE WARNING DETAIL

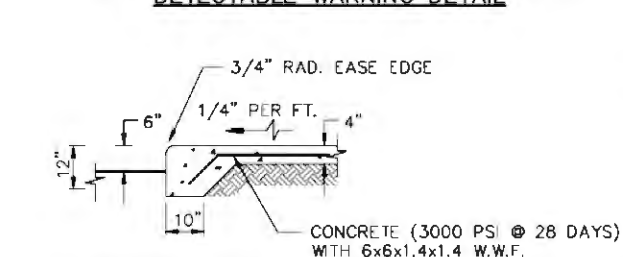

TURNDOWN SIDEWALK DETAIL

(FOR USE ADJACENT TO PAVED AREAS)

NOTES:

1. PROVIDE 1/8\"/>

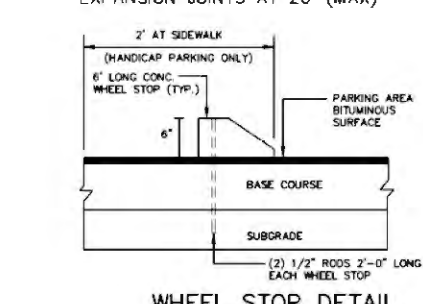

WHEEL STOP DETAIL

ES BMP 1.01

TEMPORARY GRAVEL CONSTRUCTION ENTRANCE

DEFINITION

A STONE, STABILIZED PAD LOCATED AT POINTS OF VEHICULAR INGRESS AND EGRESS ON A CONSTRUCTION SITE.

PURPOSE

TO REDUCE THE AMOUNT OF SEDIMENT TRANSPORTED ONTO PUBLIC ROADS BY MOTOR VEHICLES OR RAIN.

CONDITIONS WHERE PRACTICE APPLIES

WHEN/WHY: PRACTICE WILL BE LEAVING A CONSTRUCTION SITE AND MOVING DIRECTLY ONTO A PUBLIC ROAD OR OTHER PAVED AREA.

PLANNING CONSIDERATIONS

CONSTRUCTION ENTRANCES PROVIDE AN AREA WHERE MUD CAN BE REMOVED FROM CONSTRUCTION VEHICLE TIRES BEFORE THE ENTER A PUBLIC ROAD. IF THE ACTION OF THE VEHICLE TRAVELING OVER THE GRAVEL PAD IS NOT SUFFICIENT TO REMOVE THE MAJORITY OF THE MUD, THEN THE TIRES MUST BE WASHED BEFORE THE VEHICLE ENTERS A PUBLIC ROAD. IF WASHING IS USED, PROVISIONS MUST BE MADE TO ANTICIPATE THE WASH WATER AND TRAP THE SEDIMENT BEFORE IT IS CARRIED OFF-SITE. CONSTRUCTION ENTRANCES SHOULD BE USED IN CONJUNCTION WITH THE STABILIZATION OF CONSTRUCTION ROADS TO REDUCE THE AMOUNT OF MUD PICKED UP BY CONSTRUCTION VEHICLES.

DESIGN CRITERIA

AGGREGATE SIZE

100T AGGREGATE NO. 1 (1.5 - 3.5 INCH STONE) SHOULD BE USED.

ENTRANCE DIMENSIONS

AGGREGATE LAYER MUST BE AT LEAST 6 INCHES THICK. IT MUST EXTEND THE FULL WIDTH OF THE VEHICULAR INGRESS AND EGRESS AREA. THE LENGTH OF THE ENTRANCE MUST BE AT LEAST 50 FEET. (SEE DETAIL).

WASHING

IF CONDITIONS OF THE SITE ARE SUCH THAT THE MAJORITY OF THE MUD IS NOT REMOVED BY THE VEHICLES TRAVELING OVER THE GRAVEL PAD, THEN THE TIRES MUST BE WASHED BEFORE ENTERING A PUBLIC ROAD. WASH WATER MUST BE CARRIED AWAY FROM THE ENTRANCE TO A SETTLING AREA TO REMOVE SEDIMENT. A WASH RACK MAY ALSO BE USED TO MAKE WASHING MORE CONVENIENT AND EFFECTIVE. (SEE DETAIL).

LOCATION

THE ENTRANCE SHOULD BE LOCATED TO PROVIDE FOR MAXIMUM UTILITY BY ALL CONSTRUCTION VEHICLES.

CONSTRUCTION SPECIFICATIONS

THE AREA OF THE ENTRANCE SHOULD BE CLEARED OF ALL VEGETATION, ROOTS AND OTHER OBSTACLES. MATERIALS, THE GRAVEL SHALL BE PLACED TO THE SPECIFIED DIMENSIONS. ANY DRAINAGE FACILITIES REQUIRED DUE TO WASHING SHOULD BE CONSTRUCTED ACCORDING TO SPECIFICATIONS. IF WASH RACKS ARE USED, THEY SHOULD BE CONSTRUCTED ACCORDING TO SPECIFICATIONS. IF WASH RACKS ARE TO MANUFACTURER'S SPECIFICATIONS.

MAINTENANCE

THE ENTRANCE SHALL BE MAINTAINED IN A CONDITION WHICH WILL PREVENT TRACKING OF FLOW OF MUD ONTO PUBLIC RIGHTS-OF-WAY. PREVENT TRACKING OF FLOW OF MUD ONTO PUBLIC RIGHTS-OF-WAY. PREVENT TRACKING OF FLOW OF MUD ONTO PUBLIC RIGHTS-OF-WAY. PREVENT TRACKING OF FLOW OF MUD ONTO PUBLIC RIGHTS-OF-WAY.

CONSTRUCTION SPECIFICATIONS

THE AREA OF THE ENTRANCE SHOULD BE CLEARED OF ALL VEGETATION, ROOTS AND OTHER OBSTACLES. MATERIALS, THE GRAVEL SHALL BE PLACED TO THE SPECIFIED DIMENSIONS. ANY DRAINAGE FACILITIES REQUIRED DUE TO WASHING SHOULD BE CONSTRUCTED ACCORDING TO SPECIFICATIONS. IF WASH RACKS ARE USED, THEY SHOULD BE CONSTRUCTED ACCORDING TO SPECIFICATIONS. IF WASH RACKS ARE TO MANUFACTURER'S SPECIFICATIONS.

MAINTENANCE

THE ENTRANCE SHALL BE MAINTAINED IN A CONDITION WHICH WILL PREVENT TRACKING OF FLOW OF MUD ONTO PUBLIC RIGHTS-OF-WAY. PREVENT TRACKING OF FLOW OF MUD ONTO PUBLIC RIGHTS-OF-WAY. PREVENT TRACKING OF FLOW OF MUD ONTO PUBLIC RIGHTS-OF-WAY. PREVENT TRACKING OF FLOW OF MUD ONTO PUBLIC RIGHTS-OF-WAY.

CONSTRUCTION SPECIFICATIONS

THE AREA OF THE ENTRANCE SHOULD BE CLEARED OF ALL VEGETATION, ROOTS AND OTHER OBSTACLES. MATERIALS, THE GRAVEL SHALL BE PLACED TO THE SPECIFIED DIMENSIONS. ANY DRAINAGE FACILITIES REQUIRED DUE TO WASHING SHOULD BE CONSTRUCTED ACCORDING TO SPECIFICATIONS. IF WASH RACKS ARE USED, THEY SHOULD BE CONSTRUCTED ACCORDING TO SPECIFICATIONS. IF WASH RACKS ARE TO MANUFACTURER'S SPECIFICATIONS.

MAINTENANCE

THE ENTRANCE SHALL BE MAINTAINED IN A CONDITION WHICH WILL PREVENT TRACKING OF FLOW OF MUD ONTO PUBLIC RIGHTS-OF-WAY. PREVENT TRACKING OF FLOW OF MUD ONTO PUBLIC RIGHTS-OF-WAY. PREVENT TRACKING OF FLOW OF MUD ONTO PUBLIC RIGHTS-OF-WAY. PREVENT TRACKING OF FLOW OF MUD ONTO PUBLIC RIGHTS-OF-WAY.

CONSTRUCTION SPECIFICATIONS

THE AREA OF THE ENTRANCE SHOULD BE CLEARED OF ALL VEGETATION, ROOTS AND OTHER OBSTACLES. MATERIALS, THE GRAVEL SHALL BE PLACED TO THE SPECIFIED DIMENSIONS. ANY DRAINAGE FACILITIES REQUIRED DUE TO WASHING SHOULD BE CONSTRUCTED ACCORDING TO SPECIFICATIONS. IF WASH RACKS ARE USED, THEY SHOULD BE CONSTRUCTED ACCORDING TO SPECIFICATIONS. IF WASH RACKS ARE TO MANUFACTURER'S SPECIFICATIONS.

MAINTENANCE

THE ENTRANCE SHALL BE MAINTAINED IN A CONDITION WHICH WILL PREVENT TRACKING OF FLOW OF MUD ONTO PUBLIC RIGHTS-OF-WAY. PREVENT TRACKING OF FLOW OF MUD ONTO PUBLIC RIGHTS-OF-WAY. PREVENT TRACKING OF FLOW OF MUD ONTO PUBLIC RIGHTS-OF-WAY. PREVENT TRACKING OF FLOW OF MUD ONTO PUBLIC RIGHTS-OF-WAY.

CONSTRUCTION SPECIFICATIONS

THE AREA OF THE ENTRANCE SHOULD BE CLEARED OF ALL VEGETATION, ROOTS AND OTHER OBSTACLES. MATERIALS, THE GRAVEL SHALL BE PLACED TO THE SPECIFIED DIMENSIONS. ANY DRAINAGE FACILITIES REQUIRED DUE TO WASHING SHOULD BE CONSTRUCTED ACCORDING TO SPECIFICATIONS. IF WASH RACKS ARE USED, THEY SHOULD BE CONSTRUCTED ACCORDING TO SPECIFICATIONS. IF WASH RACKS ARE TO MANUFACTURER'S SPECIFICATIONS.

MAINTENANCE

THE ENTRANCE SHALL BE MAINTAINED IN A CONDITION WHICH WILL PREVENT TRACKING OF FLOW OF MUD ONTO PUBLIC RIGHTS-OF-WAY. PREVENT TRACKING OF FLOW OF MUD ONTO PUBLIC RIGHTS-OF-WAY. PREVENT TRACKING OF FLOW OF MUD ONTO PUBLIC RIGHTS-OF-WAY. PREVENT TRACKING OF FLOW OF MUD ONTO PUBLIC RIGHTS-OF-WAY.

CONSTRUCTION SPECIFICATIONS

THE AREA OF THE ENTRANCE SHOULD BE CLEARED OF ALL VEGETATION, ROOTS AND OTHER OBSTACLES. MATERIALS, THE GRAVEL SHALL BE PLACED TO THE SPECIFIED DIMENSIONS. ANY DRAINAGE FACILITIES REQUIRED DUE TO WASHING SHOULD BE CONSTRUCTED ACCORDING TO SPECIFICATIONS. IF WASH RACKS ARE USED, THEY SHOULD BE CONSTRUCTED ACCORDING TO SPECIFICATIONS. IF WASH RACKS ARE TO MANUFACTURER'S SPECIFICATIONS.

MAINTENANCE

THE ENTRANCE SHALL BE MAINTAINED IN A CONDITION WHICH WILL PREVENT TRACKING OF FLOW OF MUD ONTO PUBLIC RIGHTS-OF-WAY. PREVENT TRACKING OF FLOW OF MUD ONTO PUBLIC RIGHTS-OF-WAY. PREVENT TRACKING OF FLOW OF MUD ONTO PUBLIC RIGHTS-OF-WAY. PREVENT TRACKING OF FLOW OF MUD ONTO PUBLIC RIGHTS-OF-WAY.

CONSTRUCTION SPECIFICATIONS

THE AREA OF THE ENTRANCE SHOULD BE CLEARED OF ALL VEGETATION, ROOTS AND OTHER OBSTACLES. MATERIALS, THE GRAVEL SHALL BE PLACED TO THE SPECIFIED DIMENSIONS. ANY DRAINAGE FACILITIES REQUIRED DUE TO WASHING SHOULD BE CONSTRUCTED ACCORDING TO SPECIFICATIONS. IF WASH RACKS ARE USED, THEY SHOULD BE CONSTRUCTED ACCORDING TO SPECIFICATIONS. IF WASH RACKS ARE TO MANUFACTURER'S SPECIFICATIONS.

MAINTENANCE

THE ENTRANCE SHALL BE MAINTAINED IN A CONDITION WHICH WILL PREVENT TRACKING OF FLOW OF MUD ONTO PUBLIC RIGHTS-OF-WAY. PREVENT TRACKING OF FLOW OF MUD ONTO PUBLIC RIGHTS-OF-WAY. PREVENT TRACKING OF FLOW OF MUD ONTO PUBLIC RIGHTS-OF-WAY. PREVENT TRACKING OF FLOW OF MUD ONTO PUBLIC RIGHTS-OF-WAY.

CONSTRUCTION SPECIFICATIONS

THE AREA OF THE ENTRANCE SHOULD BE CLEARED OF ALL VEGETATION, ROOTS AND OTHER OBSTACLES. MATERIALS, THE GRAVEL SHALL BE PLACED TO THE SPECIFIED DIMENSIONS. ANY DRAINAGE FACILITIES REQUIRED DUE TO WASHING SHOULD BE CONSTRUCTED ACCORDING TO SPECIFICATIONS. IF WASH RACKS ARE USED, THEY SHOULD BE CONSTRUCTED ACCORDING TO SPECIFICATIONS. IF WASH RACKS ARE TO MANUFACTURER'S SPECIFICATIONS.

MAINTENANCE

THE ENTRANCE SHALL BE MAINTAINED IN A CONDITION WHICH WILL PREVENT TRACKING OF FLOW OF MUD ONTO PUBLIC RIGHTS-OF-WAY. PREVENT TRACKING OF FLOW OF MUD ONTO PUBLIC RIGHTS-OF-WAY. PREVENT TRACKING OF FLOW OF MUD ONTO PUBLIC RIGHTS-OF-WAY. PREVENT TRACKING OF FLOW OF MUD ONTO PUBLIC RIGHTS-OF-WAY.

CONSTRUCTION SPECIFICATIONS

THE AREA OF THE ENTRANCE SHOULD BE CLEARED OF ALL VEGETATION, ROOTS AND OTHER OBSTACLES. MATERIALS, THE GRAVEL SHALL BE PLACED TO THE SPECIFIED DIMENSIONS. ANY DRAINAGE FACILITIES REQUIRED DUE TO WASHING SHOULD BE CONSTRUCTED ACCORDING TO SPECIFICATIONS. IF WASH RACKS ARE USED, THEY SHOULD BE CONSTRUCTED ACCORDING TO SPECIFICATIONS. IF WASH RACKS ARE TO MANUFACTURER'S SPECIFICATIONS.

MAINTENANCE

THE ENTRANCE SHALL BE MAINTAINED IN A CONDITION WHICH WILL PREVENT TRACKING OF FLOW OF MUD ONTO PUBLIC RIGHTS-OF-WAY. PREVENT TRACKING OF FLOW OF MUD ONTO PUBLIC RIGHTS-OF-WAY. PREVENT TRACKING OF FLOW OF MUD ONTO PUBLIC RIGHTS-OF-WAY. PREVENT TRACKING OF FLOW OF MUD ONTO PUBLIC RIGHTS-OF-WAY.

CONSTRUCTION SPECIFICATIONS

THE AREA OF THE ENTRANCE SHOULD BE CLEARED OF ALL VEGETATION, ROOTS AND OTHER OBSTACLES. MATERIALS, THE GRAVEL SHALL BE PLACED TO THE SPECIFIED DIMENSIONS. ANY DRAINAGE FACILITIES REQUIRED DUE TO WASHING SHOULD BE CONSTRUCTED ACCORDING TO SPECIFICATIONS. IF WASH RACKS ARE USED, THEY SHOULD BE CONSTRUCTED ACCORDING TO SPECIFICATIONS. IF WASH RACKS ARE TO MANUFACTURER'S SPECIFICATIONS.

MAINTENANCE

THE ENTRANCE SHALL BE MAINTAINED IN A CONDITION WHICH WILL PREVENT TRACKING OF FLOW OF MUD ONTO PUBLIC RIGHTS-OF-WAY. PREVENT TRACKING OF FLOW OF MUD ONTO PUBLIC RIGHTS-OF-WAY. PREVENT TRACKING OF FLOW OF MUD ONTO PUBLIC RIGHTS-OF-WAY. PREVENT TRACKING OF FLOW OF MUD ONTO PUBLIC RIGHTS-OF-WAY.

CONSTRUCTION SPECIFICATIONS

THE AREA OF THE ENTRANCE SHOULD BE CLEARED OF ALL VEGETATION, ROOTS AND OTHER OBSTACLES. MATERIALS, THE GRAVEL SHALL BE PLACED TO THE SPECIFIED DIMENSIONS. ANY DRAINAGE FACILITIES REQUIRED DUE TO WASHING SHOULD BE CONSTRUCTED ACCORDING TO SPECIFICATIONS. IF WASH RACKS ARE USED, THEY SHOULD BE CONSTRUCTED ACCORDING TO SPECIFICATIONS. IF WASH RACKS ARE TO MANUFACTURER'S SPECIFICATIONS.

MAINTENANCE

THE ENTRANCE SHALL BE MAINTAINED IN A CONDITION WHICH WILL PREVENT TRACKING OF FLOW OF MUD ONTO PUBLIC RIGHTS-OF-WAY. PREVENT TRACKING OF FLOW OF MUD ONTO PUBLIC RIGHTS-OF-WAY. PREVENT TRACKING OF FLOW OF MUD ONTO PUBLIC RIGHTS-OF-WAY. PREVENT TRACKING OF FLOW OF MUD ONTO PUBLIC RIGHTS-OF-WAY.

CONSTRUCTION SPECIFICATIONS

THE AREA OF THE ENTRANCE SHOULD BE CLEARED OF ALL VEGETATION, ROOTS AND OTHER OBSTACLES. MATERIALS, THE GRAVEL SHALL BE PLACED TO THE SPECIFIED DIMENSIONS. ANY DRAINAGE FACILITIES REQUIRED DUE TO WASHING SHOULD BE CONSTRUCTED ACCORDING TO SPECIFICATIONS. IF WASH RACKS ARE USED, THEY SHOULD BE CONSTRUCTED ACCORDING TO SPECIFICATIONS. IF WASH RACKS ARE TO MANUFACTURER'S SPECIFICATIONS.

MAINTENANCE

THE ENTRANCE SHALL BE MAINTAINED IN A CONDITION WHICH WILL PREVENT TRACKING OF FLOW OF MUD ONTO PUBLIC RIGHTS-OF-WAY. PREVENT TRACKING OF FLOW OF MUD ONTO PUBLIC RIGHTS-OF-WAY. PREVENT TRACKING OF FLOW OF MUD ONTO PUBLIC RIGHTS-OF-WAY. PREVENT TRACKING OF FLOW OF MUD ONTO PUBLIC RIGHTS-OF-WAY.

CONSTRUCTION SPECIFICATIONS

THE AREA OF THE ENTRANCE SHOULD BE CLEARED OF ALL VEGETATION, ROOTS AND OTHER OBSTACLES. MATERIALS, THE GRAVEL SHALL BE PLACED TO THE SPECIFIED DIMENSIONS. ANY DRAINAGE FACILITIES REQUIRED DUE TO WASHING SHOULD BE CONSTRUCTED ACCORDING TO SPECIFICATIONS. IF WASH RACKS ARE USED, THEY SHOULD BE CONSTRUCTED ACCORDING TO SPECIFICATIONS. IF WASH RACKS ARE TO MANUFACTURER'S SPECIFICATIONS.

MAINTENANCE

THE ENTRANCE SHALL BE MAINTAINED IN A CONDITION WHICH WILL PREVENT TRACKING OF FLOW OF MUD ONTO PUBLIC RIGHTS-OF-WAY. PREVENT TRACKING OF FLOW OF MUD ONTO PUBLIC RIGHTS-OF-WAY. PREVENT TRACKING OF FLOW OF MUD ONTO PUBLIC RIGHTS-OF-WAY. PREVENT TRACKING OF FLOW OF MUD ONTO PUBLIC RIGHTS-OF-WAY.

CONSTRUCTION SPECIFICATIONS

THE AREA OF THE ENTRANCE SHOULD BE CLEARED OF ALL VEGETATION, ROOTS AND OTHER OBSTACLES. MATERIALS, THE GRAVEL SHALL BE PLACED TO THE SPECIFIED DIMENSIONS. ANY DRAINAGE FACILITIES REQUIRED DUE TO WASHING SHOULD BE CONSTRUCTED ACCORDING TO SPECIFICATIONS. IF WASH RACKS ARE USED, THEY SHOULD BE CONSTRUCTED ACCORDING TO SPECIFICATIONS. IF WASH RACKS ARE TO MANUFACTURER'S SPECIFICATIONS.

MAINTENANCE

THE ENTRANCE SHALL BE MAINTAINED IN A CONDITION WHICH WILL PREVENT TRACKING OF FLOW OF MUD ONTO PUBLIC RIGHTS-OF-WAY. PREVENT TRACKING OF FLOW OF MUD ONTO PUBLIC RIGHTS-OF-WAY. PREVENT TRACKING OF FLOW OF MUD ONTO PUBLIC RIGHTS-OF-WAY. PREVENT TRACKING OF FLOW OF MUD ONTO PUBLIC RIGHTS-OF-WAY.

CONSTRUCTION SPECIFICATIONS

THE AREA OF THE ENTRANCE SHOULD BE CLEARED OF ALL VEGETATION, ROOTS AND OTHER OBSTACLES. MATERIALS, THE GRAVEL SHALL BE PLACED TO THE SPECIFIED DIMENSIONS. ANY DRAINAGE FACILITIES REQUIRED DUE TO WASHING SHOULD BE CONSTRUCTED ACCORDING TO SPECIFICATIONS. IF WASH RACKS ARE USED, THEY SHOULD BE CONSTRUCTED ACCORDING TO SPECIFICATIONS. IF WASH RACKS ARE TO MANUFACTURER'S SPECIFICATIONS.

MAINTENANCE

THE ENTRANCE SHALL BE MAINTAINED IN A CONDITION WHICH WILL PREVENT TRACKING OF FLOW OF MUD ONTO PUBLIC RIGHTS-OF-WAY. PREVENT TRACKING OF FLOW OF MUD ONTO PUBLIC RIGHTS-OF-WAY. PREVENT TRACKING OF FLOW OF MUD ONTO PUBLIC RIGHTS-OF-WAY. PREVENT TRACKING OF FLOW OF MUD ONTO PUBLIC RIGHTS-OF-WAY.

CONSTRUCTION SPECIFICATIONS

THE AREA OF THE ENTRANCE SHOULD BE CLEARED OF ALL VEGETATION, ROOTS AND OTHER OBSTACLES. MATERIALS, THE GRAVEL SHALL BE PLACED TO THE SPECIFIED DIMENSIONS. ANY DRAINAGE FACILITIES REQUIRED DUE TO WASHING SHOULD BE CONSTRUCTED ACCORDING TO SPECIFICATIONS. IF WASH RACKS ARE USED, THEY SHOULD BE CONSTRUCTED ACCORDING TO SPECIFICATIONS. IF WASH RACKS ARE TO MANUFACTURER'S SPECIFICATIONS.

MAINTENANCE

THE ENTRANCE SHALL BE MAINTAINED IN A CONDITION WHICH WILL PREVENT TRACKING OF FLOW OF MUD ONTO PUBLIC RIGHTS-OF-WAY. PREVENT TRACKING OF FLOW OF MUD ONTO PUBLIC RIGHTS-OF-WAY. PREVENT TRACKING OF FLOW OF MUD ONTO PUBLIC RIGHTS-OF-WAY. PREVENT TRACKING OF FLOW OF MUD ONTO PUBLIC RIGHTS-OF-WAY.

CONSTRUCTION SPECIFICATIONS

THE AREA OF THE ENTRANCE SHOULD BE CLEARED OF ALL VEGETATION, ROOTS AND OTHER OBSTACLES. MATERIALS, THE GRAVEL SHALL BE PLACED TO THE SPECIFIED DIMENSIONS. ANY DRAINAGE FACILITIES REQUIRED DUE TO WASHING SHOULD BE CONSTRUCTED ACCORDING TO SPECIFICATIONS. IF WASH RACKS ARE USED, THEY SHOULD BE CONSTRUCTED ACCORDING TO SPECIFICATIONS. IF WASH RACKS ARE TO MANUFACTURER'S SPECIFICATIONS.

MAINTENANCE

THE ENTRANCE SHALL BE MAINTAINED IN A CONDITION WHICH WILL PREVENT TRACKING OF FLOW OF MUD ONTO PUBLIC RIGHTS-OF-WAY. PREVENT TRACKING OF FLOW OF MUD ONTO PUBLIC RIGHTS-OF-WAY. PREVENT TRACKING OF FLOW OF MUD ONTO PUBLIC RIGHTS-OF-WAY. PREVENT TRACKING OF FLOW OF MUD ONTO PUBLIC RIGHTS-OF-WAY.

CONSTRUCTION SPECIFICATIONS

THE AREA OF THE ENTRANCE SHOULD BE CLEARED OF ALL VEGETATION, ROOTS AND OTHER OBSTACLES. MATERIALS, THE GRAVEL SHALL BE PLACED TO THE SPECIFIED DIMENSIONS. ANY DRAINAGE FACILITIES REQUIRED DUE TO WASHING SHOULD BE CONSTRUCTED ACCORDING TO SPECIFICATIONS. IF WASH RACKS ARE USED, THEY SHOULD BE CONSTRUCTED ACCORDING TO SPECIFICATIONS. IF WASH RACKS ARE TO MANUFACTURER'S SPECIFICATIONS.

MAINTENANCE

THE ENTRANCE SHALL BE MAINTAINED IN A CONDITION WHICH WILL PREVENT TRACKING OF FLOW OF MUD ONTO PUBLIC RIGHTS-OF-WAY. PREVENT TRACKING OF FLOW OF MUD ONTO PUBLIC RIGHTS-OF-WAY. PREVENT TRACKING OF FLOW OF MUD ONTO PUBLIC RIGHTS-OF-WAY. PREVENT TRACKING OF FLOW OF MUD ONTO PUBLIC RIGHTS-OF-WAY.

CONSTRUCTION SPECIFICATIONS

THE AREA OF THE ENTRANCE SHOULD BE CLEARED OF ALL VEGETATION, ROOTS AND OTHER OBSTACLES. MATERIALS, THE GRAVEL SHALL BE PLACED TO THE SPECIFIED DIMENSIONS. ANY DRAINAGE FACILITIES REQUIRED DUE TO WASHING SHOULD BE CONSTRUCTED ACCORDING TO SPECIFICATIONS. IF WASH RACKS ARE USED, THEY SHOULD BE CONSTRUCTED ACCORDING TO SPECIFICATIONS. IF WASH RACKS ARE TO MANUFACTURER'S SPECIFICATIONS.

MAINTENANCE

THE ENTRANCE SHALL BE MAINTAINED IN A CONDITION WHICH WILL PREVENT TRACKING OF FLOW OF MUD ONTO PUBLIC RIGHTS-OF-WAY. PREVENT TRACKING OF FLOW OF MUD ONTO PUBLIC RIGHTS-OF-WAY. PREVENT TRACKING OF FLOW OF MUD ONTO PUBLIC RIGHTS-OF-WAY. PREVENT TRACKING OF FLOW OF MUD ONTO PUBLIC RIGHTS-OF-WAY.

NOTES:

1. ALL CURBS TO BE CONSTRUCTED OF 28 DAY, 3000 P.S.I. CONCRETE REINFORCED W/ #5 REBAR OR FIBERMESH
2. 1/2\"/>

STANDARD CONSTRUCTION DETAIL

STANDARD CURB CONSTRUCTION

2016-03-21

FILE NAME:

EW_R9.DWG

DETAIL REF:

R-9

STANDARD CONSTRUCTION DETAIL

SILT FENCE TURBIDITY BARRIER

2016-03-21

FILE NAME:

EW_R22.DWG

DETAIL REF:

R-22

| | IN CITY RIGHT-OF-WAY: | ON PRIVATE PROPERTY (COMMERCIAL OR MULTI-FAMILY): |
|--|--|---|
| TRANSVERSE (FROM ROAD TO PROPERTY) | MIN: 9' (1-WAY), 20' (2-WAY) TYP: 24' (2-WAY) MAX: PER LOC. | MIN: 18' TYP: 20' MAX: 50% R/W |
| LONGITUDINAL (E.G. IMPROVING A SHELL ROAD) | MIN: 18' TYP: 20' MAX: 50% R/W | MIN: 18' TYP: 20' MAX: 50% R/W |
| DRIVEWAY WIDTH | MIN: 9' (1-WAY), 20' (2-WAY) TYP: 24' (2-WAY) MAX: PER LOC. | MIN: 18' TYP: 20' MAX: 50% R/W |
| TURN-OUT GEOMETRY | ≤ 30-45 MPH: R=25' MIN (SEE NOTE 5) > 45 MPH: FDOT STANDARD | ≤ 30-45 MPH: R=25' MIN (SEE NOTE 5) > 45 MPH: FDOT STANDARD |
| ALLOWABLE MATERIALS | ASPHALT (PER DETAIL R-1, ITEMS E, F, & G) CONCRETE (PER DETAIL R-19) THE FOLLOWING ARE BY WRITTEN CONSENT ONLY: PAVERS (OR SIMILAR) THE FOLLOWING ARE NOT ALLOWED: TURFBLOCK (OR SIMILAR) GRANULAR MATERIALS PAVED WHEELPATHS | ASPHALT (PER DETAIL R-1, ITEMS E, F, & G) CONCRETE (PER DETAIL R-19) THE FOLLOWING ARE BY WRITTEN CONSENT ONLY: PAVERS (OR SIMILAR) TURFBLOCK (OR SIMILAR) IMPROVED GRANULAR MATLS THE FOLLOWING ARE NOT ALLOWED: TURFBLOCK (OR SIMILAR) GRANULAR MATERIALS PAVED WHEELPATHS |

NOTES:

1. PAVERS, GRAVEL, MILLINGS AND OTHER IMPROVED GRANULAR OR NON-UNIFORM SURFACES ARE ONLY ALLOWED IN LIMITED APPLICATIONS OR BY WRITTEN CONSENT OF THE TECHNICAL REVIEW COMMITTEE. SUCH SURFACES ARE NOT CONSIDERED EQUAL TO HARDCAPE PAVING (I.E. CONCRETE OR ASPHALT). PROPERTY OWNERS WISHING TO INSTALL SUCH SURFACE IN CITY RIGHT-OF-WAY SHALL EXECUTE A HOLD HARMLESS AGREEMENT INDEFINING THE CITY AGAINST THE MAINTENANCE, REPAIR, AND/OR REPLACEMENT OF SIMILAR SURFACE. REQUIREMENT FOR HARDCAPE PAVING SHALL BE ENFORCED FOR ALL NEW DEVELOPMENT, ALTERNATIVE SURFACES SHALL BE ALLOWED ONLY IN MINOR RETROFIT APPLICATIONS.
2. FOR ASPHALT PAVEMENT, REFER TO ITEMS E, F, & G OF DETAIL R-1.
FOR CONCRETE PAVEMENT, REFER TO DETAIL R-19.
(THE LATEST VERSION OF FDOT SPECIFICATIONS SHALL BE ACCEPTED IN LIEU OF THE ABOVE.)
FOR ALL OTHER SURFACES:
12\"/>

STANDARD CONSTRUCTION DETAIL

DRIVEWAY DETAIL - COMMERCIAL/MULTI-FAMILY

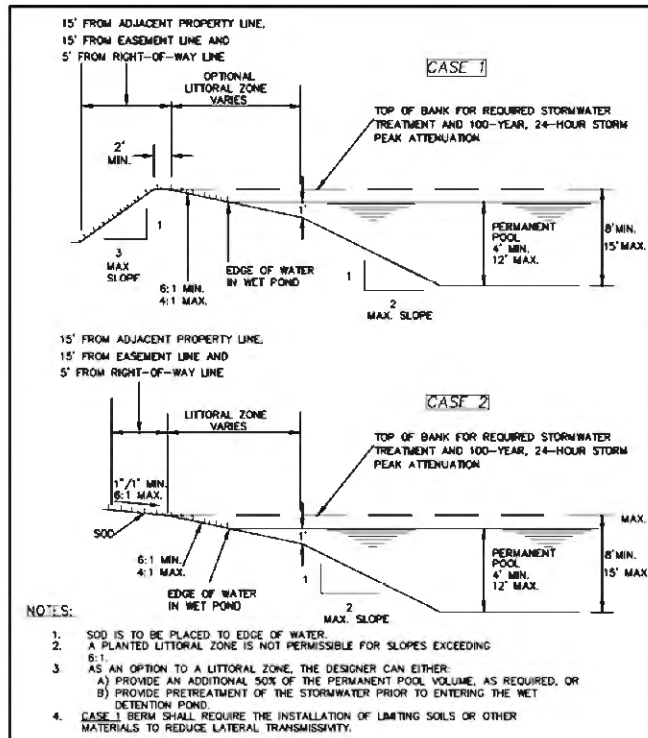

FILE NAME:

EW_ST10.DWG

DETAIL REF:

ST-10

STANDARD CONSTRUCTION DETAIL
WET RETENTION POND
PLACEMENT BY R/W AND EASEMENT LINES

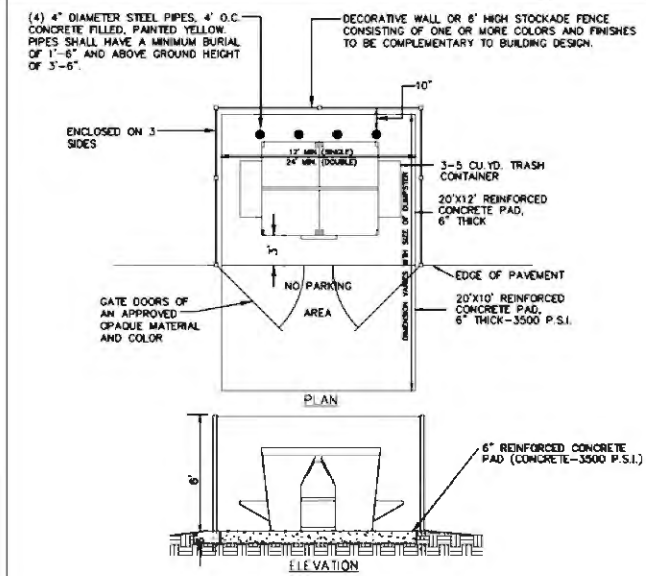

FILE NAME:

EW_M10.DWG

DETAIL REF:

M-10

STANDARD CONSTRUCTION DETAIL
HANDICAP SIGN

FILE NAME:

EW_M13.DWG

DETAIL REF:

M-13

STANDARD CONSTRUCTION DETAIL
DUMPSTER PAD

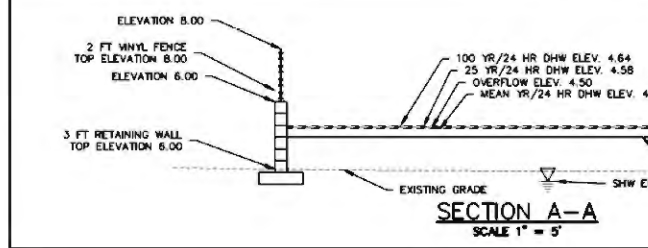

FILE NAME:

EW_M13.DWG

DETAIL REF:

M-13

STANDARD CONSTRUCTION DETAIL
DUMPSTER PAD



FILE NAME:

EW_M13.DWG

DETAIL REF:

M-13

STANDARD CONSTRUCTION DETAIL
DUMPSTER PAD



FILE NAME:

EW_M13.DWG

DETAIL REF:

M-13

STANDARD CONSTRUCTION DETAIL
DUMPSTER PAD



FILE NAME:

EW_M13.DWG

DETAIL REF:

M-13

STANDARD CONSTRUCTION DETAIL
DUMPSTER PAD



FILE NAME:

EW_M13.DWG

DETAIL REF:

M-13

STANDARD CONSTRUCTION DETAIL
DUMPSTER PAD



FILE NAME:

EW_M13.DWG

DETAIL REF:

M-13

STANDARD CONSTRUCTION DETAIL
DUMPSTER PAD



FILE NAME:

EW_M13.DWG

DETAIL REF:

M-13

STANDARD CONSTRUCTION DETAIL
DUMPSTER PAD



FILE NAME:

EW_M13.DWG

DETAIL REF:

M-13

STANDARD CONSTRUCTION DETAIL
DUMPSTER PAD



FILE NAME:

EW_M13.DWG

DETAIL REF:

M-13

STANDARD CONSTRUCTION DETAIL
DUMPSTER PAD



FILE NAME:

EW_M13.DWG

DETAIL REF:

M-13

STANDARD CONSTRUCTION DETAIL
DUMPSTER PAD



FILE NAME:

EW_M13.DWG

DETAIL REF:

M-13

STANDARD CONSTRUCTION DETAIL
DUMPSTER PAD



FILE NAME:

EW_M13.DWG

DETAIL REF:

M-13

STANDARD CONSTRUCTION DETAIL
DUMPSTER PAD



FILE NAME:

EW_M13.DWG

DETAIL REF:

M-13

STANDARD CONSTRUCTION DETAIL
DUMPSTER PAD



FILE NAME:

EW_M13.DWG

DETAIL REF:

M-13

STANDARD CONSTRUCTION DETAIL
DUMPSTER PAD



FILE NAME:

EW_M13.DWG

DETAIL REF:

M-13

STANDARD CONSTRUCTION DETAIL
DUMPSTER PAD



FILE NAME:

EW_M13.DWG

DETAIL REF:

M-13

STANDARD CONSTRUCTION DETAIL
DUMPSTER PAD



FILE NAME:

EW_M13.DWG

DETAIL REF:

M-13

STANDARD CONSTRUCTION DETAIL
DUMPSTER PAD



FILE NAME:

EW_M13.DWG

DETAIL REF:

M-13

STANDARD CONSTRUCTION DETAIL
DUMPSTER PAD



FILE NAME:

SANITARY SEWER DESIGN AND CONSTRUCTION NOTES

- THE CITY'S ENVIRONMENTAL SERVICES DEPT. (424-2476) SHALL BE GIVEN A MINIMUM OF 48 HOURS ADVANCE NOTICE (NOT INCLUDING HOLIDAYS OR WEEKENDS) PRIOR TO BEGINNING ANY SANITARY SEWER CONSTRUCTION.
- ALL GRAVITY SANITARY SEWER MAIN LINES SHALL BE 8" DIAMETER MINIMUM. COMMERCIAL SERVICE LATERALS WITH MULTIPLE CONNECTIONS SHALL BE GREEN 6" DIA. OR LARGER. ALL SINGLE FAMILY RESIDENTIAL SERVICE LATERALS SHALL BE 4" - SINGLE SERVICES.
- ALL GRAVITY SANITARY SEWER LINES SHALL BE GREEN PVC SDR 26, ASTM D-3034, IN PLACES WHERE A MINIMUM COVER OF 4' CANNOT BE MAINTAINED. AWWA C-900 OR C-905 GREEN PVC DR-25, CLASS 100 OR CONCRETE ENCASEMENT SHALL BE USED. WATER LINES, RECLAIMED LINES, AND STORM DRAINAGE CROSSINGS SHALL ALSO FOLLOW THE CONCRETE ENCASEMENT REQUIREMENT PER THESE STANDARDS AND AS PER REGULATORY REQUIREMENTS.
- MINIMUM GRAVITY SANITARY SEWER SLOPES ARE AS FOLLOWS:
8" PIPE 0.40 %
10" PIPE 0.30 %
12" PIPE 0.22 %
- GRAVITY SANITARY SEWER LINES SHALL BE INSTALLED WHENEVER POSSIBLE UNDER PAVED AREAS WITHIN PUBLIC RIGHTS-OF-WAY. UTILITY EASEMENTS SHALL BE PROVIDED WHENEVER PUBLICLY-OWNED SEWER LINES ARE CONSTRUCTED OUTSIDE OF A PUBLIC RIGHT-OF-WAY.
- GRAVITY SANITARY SEWER LINE CONSTRUCTION SHALL BE ACCOMPLISHED BY THE USE OF A LASER INSTRUMENT UNLESS ANOTHER METHOD IS PREVIOUSLY APPROVED BY THE CITY.
- THE CONTRACTOR SHALL, AT ALL TIMES, DURING PIPE LAYING OPERATIONS, DEWATER THE GROUND SUFFICIENTLY TO KEEP THE GROUNDWATER ELEVATION A MINIMUM OF 6" BELOW THE PIPE BEING LAID WITHIN THE AREA OF THE TRENCH.
- ALL PIPES SHALL BE LAID ON A FIRM FOUNDATION. SOFT OR SPONGY BEDDING FOR PIPES IS NOT ACCEPTABLE. ANY UNSUITABLE MATERIAL SHALL BE REMOVED AND REPLACED WITH A DRY, COMPACTED, GRANULAR MATERIAL SATISFACTORY TO THE CITY.
- ON ALL EXCAVATION AND BACKFILLING THE CONTRACTOR SHALL PROVIDE ADEQUATE SHEETING AND BRACING IN ORDER TO PROVIDE FOR THE SAFETY OF WORKMEN, AS WELL AS REPRESENTATIVES OF THE CITY, THE DESIGN ENGINEER, AND THE DEVELOPER.
- ALL TRENCHES SHALL BE BACKFILLED WITH ACCEPTABLE MATERIAL AND COMPACTED TO THE SPECIFIED MINIMUM COMPACTION (95% IN UNPAVED AREAS AND 98% IN PAVED AREAS) OF THE OPTIMUM DENSITY OF THAT MATERIAL BASED ON THE AASHTO T-180 MODIFIED PROCTOR TEST.
- THE CONTRACTOR SHALL EMPLOY AN INDEPENDENT TESTING LABORATORY AT HIS OWN EXPENSE TO INSURE THAT COMPACTION OF ALL FILL MATERIAL IS COMPLETED PROPERLY. TESTS SHALL BE DONE ONE FOOT ABOVE THE PIPE AND THEN AT ONE FOOT VERTICAL INTERVALS UNTIL FINAL GRADE IS REACHED. TESTING SHALL BE COMPLETED AND TEST DOCUMENTS SUBMITTED TO THE CITY AT A MINIMUM FREQUENCY OF ONE SET OF TESTS BETWEEN EACH MANHOLE AND ONE ADDITIONAL SET OF TESTS AT EVERY MANHOLE. IDENTIFICATION OF TEST LOCATIONS SHALL BE CLEARLY INDICATED ON TEST REPORTS. TEST RESULTS SHALL BE FORWARDED PROMPTLY TO THE CITY'S DESIGNATED SITE INSPECTOR.
- THE CONTRACTOR SHALL INSTALL A METALLIZED FOIL LOCATOR TAPE, OR SIMILAR DEVICE AS MAY BE APPROVED BY THE CITY FOR THE FULL LENGTH OF ALL PVC SEWAGE FORCE MAINS. THIS PIPE LOCATOR AND SHALL BE INSTALLED BETWEEN 15" AND 24" BELOW FINISHED GRADE OR AS DIRECTED BY THE MANUFACTURER. TAPE SHALL BE COLOR CODED GREEN FOR SANITARY SEWER AND FORCE MAIN. INSTALL 12 GAUGE TRACING WIRE IN TRENCH.
- ALL TESTING REQUIRED BY THE CITY SHALL BE PAID FOR BY THE CONTRACTOR / DEVELOPER.
- ALL LOCAL COLLECTION SANITARY SEWER MANHOLES SHALL BE PRECAST WITH A MINIMUM INSIDE DIAMETER OF 4 FEET.
- STANDARD MANHOLES SHALL BE LOCATED AT INTERVALS NOT EXCEEDING 400 FEET.
- ALL SEWER FITTINGS TO BE "HARCO" OR CITY APPROVED EQUAL.
- MANHOLE RIMS SHALL MATCH FLUSH WITH THE FINISH GRADE ELEVATION IN PAVED AREAS AND A MINIMUM OF 0.2 FEET AND MAXIMUM OF 0.5 FEET ABOVE GRADE GENERALLY IN UNPAVED AREAS.
- THE CONTRACTOR SHALL CONSTRUCT SANITARY SEWER MANHOLES IN SUCH A WAY THAT SEWER LINES DO NOT INTERSECT SEALED JOINTS BETWEEN SECTIONS OF THE MANHOLE.
- RUBBER BOOTS AND STAINLESS STEEL BANDS SHALL BE UTILIZED IN THE CONNECTION OF THE SEWER MAIN TO THE MANHOLES (SEE STANDARD MANHOLE AND BOOT DETAIL).
- INDIVIDUAL SANITARY SERVICE CONNECTORS ON NEW CONSTRUCTION SHALL NOT BE CONNECTED DIRECTLY INTO MANHOLES, AND MUST CONNECT TO SEWER MAIN LINES BY USE OF THE CONNECTIONS, UNLESS OTHERWISE BE APPROVED BY THE CITY.
- FOR SINGLE FAMILY HOMES, SINGLE OR DOUBLE FOUR INCH SEWER SERVICES LATERALS SHALL BE CONSTRUCTED SINGLES AT EACH LOT OR UNIT AND LOCATED ON THE DOWNSTREAM SIDE OF THE LOT CENTER LINE. DOUBLES LOCATED ON THE LOT LINES THESE SERVICES SHALL BE EXTENDED 4 FEET ABOVE GROUND AT THE PROPERTY LINE WITH A PVC RISER AND PLUG BEING EASILY ACCESSIBLE FROM THE ROAD. RUBBER SEAL FITTINGS SHALL BE USED ON ALL LINES. NO GLUED JOINTS ARE PERMITTED ON LATERALS, INCLUDING DOUBLES.
- FOR MULTI-FAMILY AND COMMERCIAL SITES, SIX INCH MINIMUM SEWER SERVICES AND CLEANSOUTS SHALL BE PROVIDED AS APPROVED BY THE CITY.
- SANITARY SEWER LIFT STATIONS AND FORCE MAINS, SIZE, MATERIAL, AND DESIGNS SHALL BE APPROVED BY THE CITY. LIFT STATIONS SHALL BE CONSTRUCTED WITH A MINIMUM NET WELL INTERIOR DIAMETER OF 6 FEET. FORCE MAINS SHALL BE A MINIMUM 6 INCH DIAMETER.
- IT SHALL BE THE RESPONSIBILITY OF THE DESIGN ENGINEER TO PREPARE AND SUBMIT FLOTATION CALCULATIONS TO SIZE THE BASE OF THE NET WELL, AND ANY MANHOLES AS DEEMED NECESSARY BY THE CITY.
- SANITARY SEWER DROP MANHOLES SHALL ONLY BE USED UNDER SPECIAL CONDITIONS AS APPROVED BY THE CITY. DROPS LESS THAN 2.0' SHALL NOT BE ALLOWED.
- ALL SANITARY SEWER MANHOLE COVERS SHALL HAVE THE WORDS "EDGEWATER, FLORIDA SANITARY SEWER" CAST INTO THEM.
- ALL SANITARY SEWER FORCE MAINS, SHALL BE PVC AWWA C-900, OR C-905 (COLOR "GREEN") (PRESSURE FITTINGS, PRESSURE CLASS 150 OR 250 EPOXY LINED DIP. THE FORCE MAIN MINIMUM DEPTH OF COVER SHALL BE 36".
- ALL SANITARY SEWER FORCE MAINS SHALL USE A THRUST RESTRAINT JOINT METHOD IN COMPLIANCE WITH THE DUCTILE IRON PIPE RESEARCH ASSOCIATION GUIDELINES. MODIFIED TO ACCOMMODATE PVC PIPE BY FOLLOWING THE RECOMMENDED INCREASE IN RESTRAINT LENGTH CORRESPONDING TO THE INSTALLATION OF POLYETHYLENE WRAP. IN NO INSTANCE SHALL THRUST BLOCKS BE PERMITTED.
- SANITARY SEWER MANHOLES WHICH HAVE SEWER FORCE MAINS DISCHARGING DIRECTLY INTO THEM SHALL BE FIBERGLASS OR POLY-ETHYLENE LINED. RETRO-FITTING OF MANHOLES WITH LINERS SHALL BE REQUIRED WHEN NEW CONNECTIONS SUCH AS THIS ARE MADE. FIBERGLASS SHALL BE A MINIMUM 1/2" THICKNESS UNLESS APPROVED OTHERWISE BY THE CITY. OTHER TYPES OF LINING METHODS AND MATERIALS MAY BE CONSIDERED ON A CASE BY CASE BASIS. UNDER SPECIAL CIRCUMSTANCES WHERE HYDROGEN SULFIDE IS A MAJOR CONCERN MANHOLES UPSTREAM AND/OR DOWNSTREAM OF THE FORCE MAIN TIE-IN OR NET WELL MAY ALSO BE REQUIRED TO HAVE LININGS INSTALLED.
- THE CITY RESERVES THE RIGHT TO REQUIRE THE DEVELOPER TO PERFORM VACUUM TESTING OF ALL SANITARY MANHOLES, AIR TEST SEWER MAINS, AND REQUIRES THAT ALL SANITARY SEWER MAIN LINES BE TELEVIEWED PRIOR TO FINAL ACCEPTANCE. LATERALS SHALL BE TELEVIEWED UPON DEMAND BY THE CITY PRIOR TO FINAL ACCEPTANCE WHEN IT IS SUSPECTED THAT A PROBLEM EXISTS.
- ALL SEWER MAINS, PRIOR TO ACCEPTANCE BY THE CITY AND PRIOR TO ANY FINAL PAVING OPERATIONS, SHALL BE CLEANED FLUSHED AND TELEVIEWED USING A "PAN AND TILT" CAMERA BY A CITY APPROVED CONTRACTOR. THE VIDEO SHALL BE NON-STOP WITH AUDIO DESCRIBING WHAT IS BEING REVIEWED. WRITTEN VIDEO LOGS DESCRIBING THE CONDITION OF THE LINES SHALL ACCOMPANY THE TAPE SUBMISSION TO THE CITY PRIOR TO COMMENCING ANY INSTALLATION OF ASPHALT OR CONCRETE PAVEMENT. RE-TAPING MAY BE REQUIRED BY THE CITY IF ADDITIONAL CLEANING OR CORRECTIVE ACTIONS ARE NECESSARY.
- ALL MANHOLES WITH FORCE MAIN CONNECTIONS SHALL BE OUTFITTERD WITH EGRU LINERS OR OTHER TYPES OF LINERS APPROVED BY THE CITY. IN ADDITION, THE CITY MAY REQUIRE LINES TO BE INSTALLED IN AREAS WHERE THE ENVIRONMENTAL SERVICES DEPARTMENT BELIEVES THE NEED IS JUSTIFIED.
- ALL SEWER LINES WHICH ARE CONSTRUCTED OUTSIDE OF PUBLIC RIGHTS-OF-WAY WITHIN SIDE YARDS, BACKYARDS, AND OTHER POORLY ACCESSIBLE AREAS SHALL BE CONSTRUCTED OF C-900 PVC. ABSOLUTELY NO USE OF PLASTIC STYRENE FITTINGS SHALL BE ALLOWED.
- SEWER LATERAL LOCATIONS SHALL BE MARKED ALONG THE OUTSIDE OF THE CURB WITH A SAW CUT "V", OR BY A METAL TAB SET INTO THE PAVEMENT.
- CONTEC A-2000 PVC PIPE SHALL NOT BE ALLOWED FOR USE.
- EZ-WRAP PLASTIC, AS MANUFACTURED BY PRESS SEAL GASKET CORPORATION, SHALL BE USED ON THE OUTSIDE OF ALL MANHOLE AND NETWELL JOINTS. APPLY ONE LAYER OF 9" WRAP CENTERED ON EACH JOINT. A CITY INSPECTOR SHALL PERSONALLY INSPECT ALL JOINT SEALS PRIOR TO BACKFILLING OPERATIONS.

SANITARY SEWER DESIGN AND CONSTRUCTION NOTES (CONT'D.)

- ALL PROPOSED SEWER FORCE MAINS SHALL BE FLUSHED, PRESSURE TESTED AND CLEARED FOR SERVICE IN ACCORDANCE WITH THE LATEST AWWA STANDARDS AND THE FLORIDA DEPARTMENT OF ENVIRONMENTAL PROTECTION REQUIREMENTS. THE CONTRACTOR SHALL NOTIFY THE CITY'S DESIGNATED SITE INSPECTOR WHO SHALL COORDINATE WITH CITY PERSONNEL AT THE ENVIRONMENTAL SERVICES DEPARTMENT (AS APPROPRIATE) AT LEAST 24 HOURS PRIOR TO BEGINNING A FULL-DIAMETER FLUSH OF THE MAINS PRIOR TO THE COMMENCEMENT OF PRESSURE TESTING (SUBJECT TO AVAILABILITY).
- THE CITY MAY REQUIRE THE CONTRACTOR TO PIG FORCE MAINS IN EXCESS OF 6" IN DIAMETER AND PRIMARY TRANSMISSION MAINS LOCATED ON COLLECTOR AND ARTERIAL ROADWAYS. LAUNCHING AND EXTRACTION POINTS SHALL BE DETERMINED BY THE CONTRACTOR.
- ANY TIE INTO AN EXISTING MANHOLE WILL BE COORDINATED WITH THE CITY, AND ALL CONFINED SPACE HAZARDS AND PROCEDURES WILL BE FOLLOWED.
- ANY TIE INTO AN EXISTING SYSTEM WILL BE SWEPT IN THE DIRECTION OF FLOW.
- THE CONTRACTOR WILL BE RESPONSIBLE FOR ALL OSHA, DOT, OR ANY OTHER RULES & REGULATIONS THAT MAY APPLY.
- AS A GENERAL RULE, THE NUMBER OF JOINTS SHALL BE LIMITED WHENEVER POSSIBLE IN SPECIAL CASES WHERE A POINT REPAIR TO AN 8" TO 12" PVC SEWER MAIN IS REQUIRED, THE PROPER RING WRAP AROUND SLEEVE SUCH AS A JCM-210 OVERSIZED DUCTILE IRON COUPLING OR AN APPROVED EQUAL MAY BE ALLOWED BY SPECIAL APPROVAL BY THE CITY.
- ALL IN-LINE SANITARY SEWER FORCE MAIN VALVES SHALL BE RESILIENT SEAT (AWWA C-509) VALVES FEATURING A LINED DUCTILE IRON BODY.
- ALL TAPPING OF MAINS AND CORING OF MANHOLES SHALL BE COORDINATED WITH THE CITY BY AN APPROVED CONTRACTOR AND BILLED IN ACCORDANCE WITH THE ADOPTED FEE RESOLUTION. SCHEDULING OF THESE CONNECTIONS SHALL REQUIRE A MINIMUM 48 HOUR NOTIFICATION (MEASURED ON NORMAL WORK DAYS) DIRECTED TO THE CITY'S DESIGNATED SITE INSPECTOR WHO SHALL COORDINATE THE WORK DIRECTLY WITH THE ENVIRONMENTAL SERVICES DEPARTMENT. SUBSEQUENTLY, THE CONNECTION SHALL BE SCHEDULED TO COMMENCE ON THE APPROPRIATE DAY AND TIME ESTABLISHED BY CITY.
- WITH RESPECT TO TIE-IN CONNECTIONS AND CORING OPERATIONS, THE CITY RESERVES THE RIGHT TO REQUIRE CONNECTIONS TO BE PERFORMED DURING PERIODS OF LOW FLOW (MIDNIGHT TO 6:00 A.M.) IN ORDER TO MINIMIZE SERVICE DISRUPTION TO EXISTING CUSTOMERS.
- ALL WORK PERFORMED UPON SANITARY SEWER FACILITIES OWNED OR PROPOSED TO BE OWNED BY THE CITY SHALL BE CONSTRUCTED BY A LICENSED UNDERGROUND UTILITY CONTRACTOR, OR LICENSED GENERAL CONTRACTOR, WHO IS LICENSED IN THE STATE OF FLORIDA AND REGISTERED WITH THE CITY.
- UPON CONSTRUCTION COMPLETION AND ACCEPTANCE OF THE SYSTEM, IT SHALL BE THE DESIGN ENGINEER'S RESPONSIBILITY TO ENSURE THAT THE SYSTEM IS PROPERLY CERTIFIED AND ACCEPTED BY THE FLORIDA DEPARTMENT OF ENVIRONMENTAL PROTECTION AND AS-BUILTS ARE PROVIDED TO THE CITY PRIOR TO ANY USE OF THE SYSTEM.
- FOR CONSTRUCTION PURPOSES, THE PLANS SHALL DIMENSION THE LOCATION OF ALL FORCE MAINS MEASURED FROM THE BACK OF CURB (OR EDGE OF PAVEMENT, IF NO CURBING EXISTS.)
- ALL HDPE PIPE INSTALLED FOR SEWAGE FORCE MAINS SHALL BE SDR 11 UNLESS SPECIFICALLY NOTED OTHERWISE. THE HDPE PIPE SHALL BE SIZED TO MATCH THE EXTERNAL DIAMETER OF THE PVC OR DIP TO WHICH IT IS ATTACHED.
- LANDSCAPE PLANS SHALL CLEARLY DEPICT THE DESIGN LOCATION OF PLANTINGS RELATIVE TO THE LOCATION OF PUBLIC UTILITIES AND STORMWATER INFRASTRUCTURE IN ORDER TO EVALUATE POTENTIAL CONFLICTS.
- ALL UTILITY INSTALLATIONS ARE SUBJECT TO REVIEW AND APPEAL BY THE CITY OF EDGEWATER. ALL STRUCTURES AND EQUIPMENT SUPPLIED AND/OR INSTALLED SHALL MEET QUALITY AND PERFORMANCE STANDARDS PRIOR TO ACCEPTANCE. SUBSTANDARD INSTALLATIONS MAY BE REJECTED. REMEMBER MEASURES ARE SUBJECT TO CITY APPROVAL.

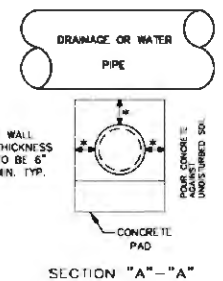
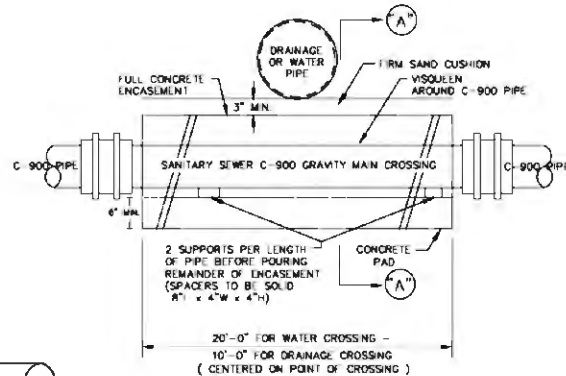

- NOTES:
- ALL CONCRETE SHALL BE 3000 PSI MINIMUM STRENGTH AT 28 DAYS.
 - WATER MAIN SHALL BE LOCATED ABOVE OR BELOW ENCASEMENT AS SHOWN ON PLANS OR AS DETERMINED IN THE FIELD. USE ENCASEMENT WHERE VERTICAL CLEARANCE WATER MAIN AND SEWER MAIN IS LESS THAN 12 INCHES.

S-6 Drawing Date: 12/18/18
SANITARY SEWER CONCRETE ENCASEMENT
NTS

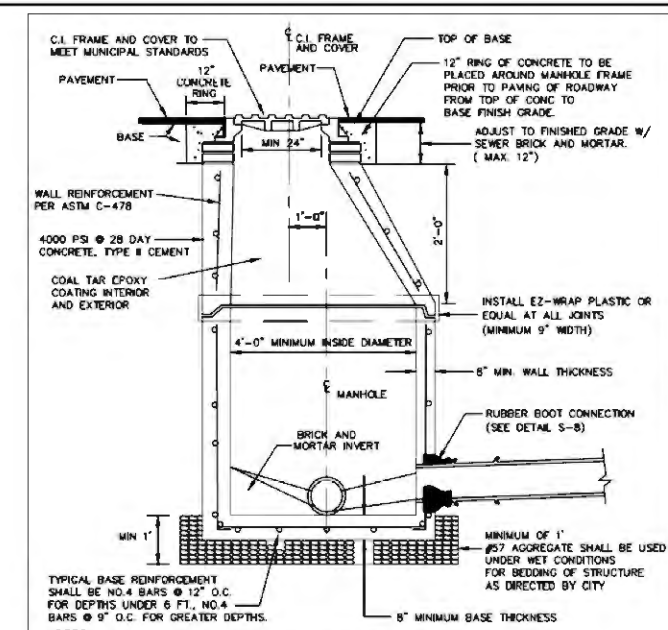

- NOTES:
- ON TRANSITIONS BETWEEN LARGER DIAMETER AND SMALLER SEWER COLLECTORS, OUTFALLS OF SEWERS SHALL BE MATCHED.
 - NON-PENETRATING PICK-HOLES IN ALL CONCRETE SECTIONS.
 - USE FIBERGLASS BITUMASTIC SEALER BETWEEN SECTIONS OF MANHOLES.
 - 0.1" - DROP ACROSS MANHOLE TOP.
 - ALL MANHOLE TROUGHS AND BENCHES ARE TO BE EPOXY PAINTED BEFORE FINAL INSPECTION.

STANDARD CONSTRUCTION DETAIL
STANDARD MANHOLE DETAIL

| | |
|-------------|-----------|
| FILE NAME: | EW_S1.DWG |
| DETAIL REF: | S-1 |

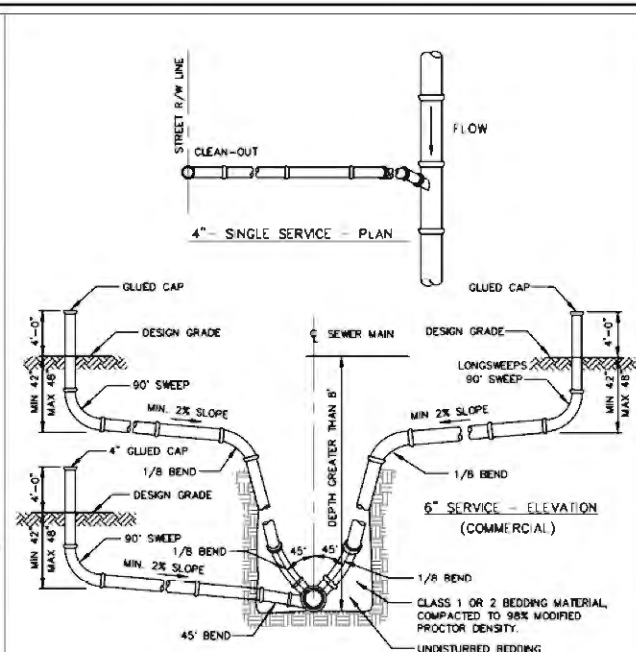

- NOTES:
- USE OF STYRENE MATERIAL WILL NOT BE PERMITTED.
 - ALL JOINTS TO BE RUBBER GASKET (NO GLUED FITTINGS) TYPICAL.
 - USE ALL HARCO SDR-26 FITTINGS OR CITY APPROVED EQUAL.

STANDARD CONSTRUCTION DETAIL
SEWER LATERAL DETAIL
(SINGLE 4" RESIDENTIAL)
(SINGLE 6" COMMERCIAL)

| | |
|-------------|------------|
| FILE NAME: | EW_S10.DWG |
| DETAIL REF: | S-10 |

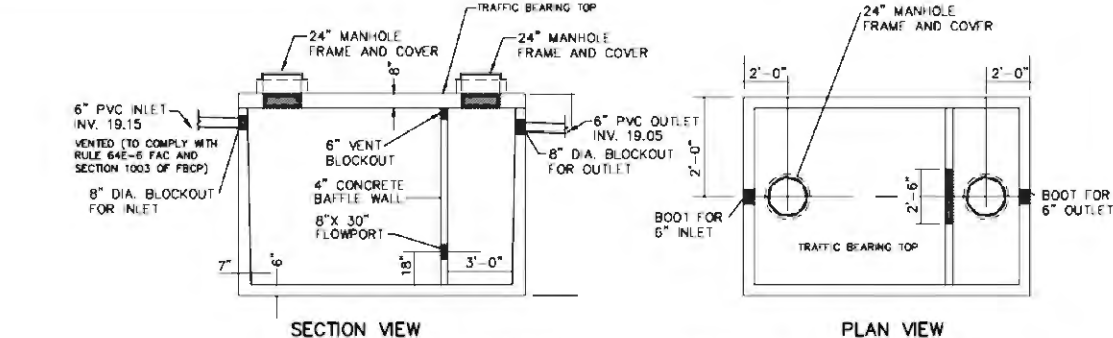

- NOTES:
- CONTRACTOR SHALL SUBMIT SHOP DRAWINGS FOR REVIEW AND APPROVAL BY THE ENGINEER AND THE CITY.
 - SHOP DRAWINGS TO INCLUDE INTERCEPTOR VENTING.
- 1500 GALLON GREASE INTERCEPTOR
NTS

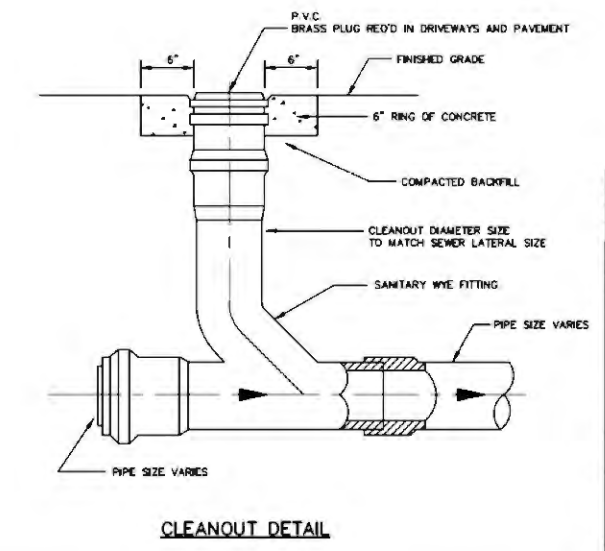

CLEANOUT DETAIL

| NO. | DATE | DESCRIPTION | BY |
|--|-------------------------|-----------------------|-----|
| 5 | 4/12/19 | REVISED PER CITY | PKM |
| 4 | 3/15/19 | REVISED PER CITY | PKM |
| 3 | 3/3/19 | REVISED | PKM |
| 2 | 11/18/18 | REVISION | PKM |
| 1 | 10/11/18 | REVISION | PKM |
| REVISIONS | | | |
| PARKER MYNCHENBERG & ASSOCIATES, INC. | | | |
| PROFESSIONAL ENGINEERS • LANDSCAPE ARCHITECTS | | | |
| 1729 RIDGEWOOD AVENUE HOLLY HILL, FLORIDA 32117 | | | |
| (386) 677-6891 FAX (386) 677-2114 E-MAIL: info@parkermynchenberg.com | | | |
| CERTIFICATE OF AUTHORIZATION NUMBER: 00003910 | | | |
| SEWER STANDARD DETAIL | | | |
| EDGEWATER MARINA | | | |
| EDGEWATER • FLORIDA | | | |
| FILE NO. 175250.DWG | DESIGNER: P.MYNCHENBERG | STATE OF FLORIDA | |
| DATE: 7/17/2018 | CADD TECH: SLB | PROFESSIONAL ENGINEER | |
| SCALE: NONE | SHEET 14 OF 14 | | |